



# ArcticNet

ᐅᐱᐅᑦᑲᑲᑲᑲᑲᑲ ᑲᐱᑲᑲᑲᑲᑲᑲᑲ



Understanding the transformation of the North is one of the great challenges faced by Canadians, the Canadian government, Inuit and northern Indigenous peoples and the national and international scientific communities.

**ArcticNet** brings together researchers in natural, human health and social sciences with their partners in Inuit organizations, northern communities, governments and the private sector to help prepare for the impacts and opportunities brought by climate change and modernization in the Arctic.

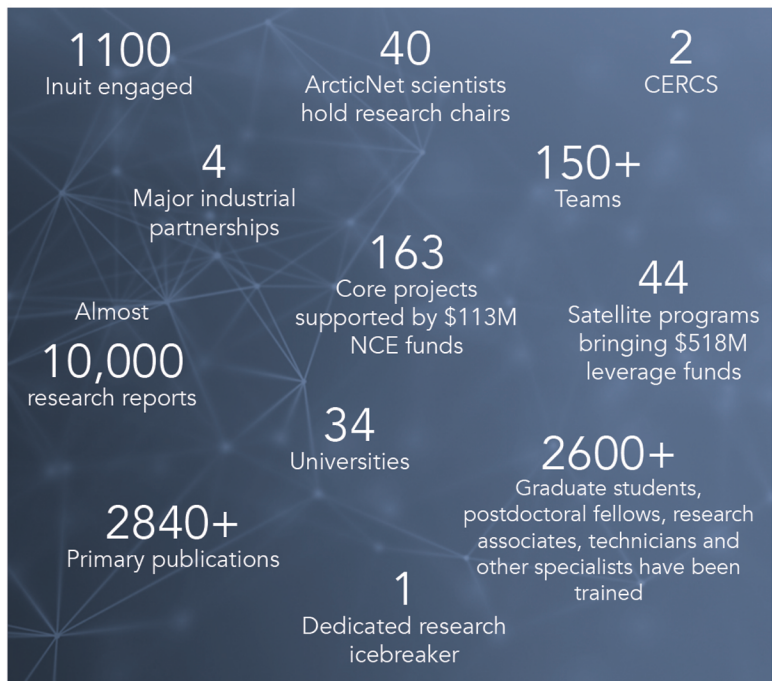

ArcticNet has formed one of the most dynamic networks of Arctic experts in the world, creating unprecedented synergy among the natural, social and health sciences and engaging Inuit at all levels

*'ArcticNet research has played an integral role for Inuit communities by helping to provide essential research results relating to our lands, waters and wildlife as well as the well-being of our people'*  
Natan Obed – Pres. Inuit Tapiriit Kanatami

Among many impacts, ArcticNet climate change research has:

- Informed the \$300M reconstruction of the Iqaluit airport
- Contributed to the banning of caribou sport hunting in Northern Québec and the establishment of a Nunavik-Nunatsiavut Committee to manage the George River herd
- Improved understanding of mercury contamination in Arctic marine ecosystems and results contributed to the development of the 2017 Minamata Convention on Mercury
- Mobilized and managed over 22 significant research programs onboard the research icebreaker Amundsen
- Trained over 2600 students of which almost 60% are women
- Provided education and training opportunities for 325 northern students
- Led to the establishment of the largest national conference on Arctic and northern science in Canada



# GENERAL PROGRAM

	MONDAY, DEC 10	TUESDAY, DEC 11	WEDNESDAY, DEC 12	THURSDAY, DEC 13	FRIDAY, DEC 14
8:30 AM – 10:00 AM	Student Day Ottawa Salon	Student Day Ottawa Salon	Plenary Session Ottawa Salon	Plenary Session Ottawa Salon	Topical Sessions
10:00 AM – 10:30 AM	Coffee Break Rideau Canal Atrium North & Colonel By Foyer South on Level 1	Coffee Break Gatineau Salon & Rideau Canal Atrium	Coffee Break Gatineau Salon & Rideau Canal Atrium	Coffee Break Gatineau Salon & Rideau Canal Atrium	Coffee Break Gatineau Salon & Rideau Canal Atrium
10:30 AM – 12:00 PM	Student Day Ottawa Salon	Student Day Ottawa Salon	Topical Sessions	Topical Sessions	Closing Plenary Session Ottawa Salon
12:00 PM – 1:30 PM	Lunch Trillium Ballroom	Networking Lunch Trillium Ballroom & Gatineau Salon	Networking Lunch Trillium Ballroom & Gatineau Salon	Lunch Canada Hall 1	Meeting Adjourns
1:30 PM – 3:00 PM	Student Day Ottawa Salon	Opening Plenary Session Ottawa Salon	Topical Sessions	Topical Sessions	
3:00 PM – 3:30 PM	Coffee Break Gatineau Salon	Coffee Break Gatineau Salon & Rideau Canal Atrium	Coffee Break Gatineau Salon & Rideau Canal Atrium	Coffee Break Gatineau Salon & Rideau Canal Atrium	
3:30 PM – 5:00 PM	Student Day Ottawa Salon	Topical Sessions	Topical Sessions	Topical Sessions	
4:30 PM – 7:00 PM		Welcome Reception Poster Session Gatineau Salon	Reception Poster Session Gatineau Salon	POLAR-ArcticNet Women in Northern Science Networking Reception and Panel Discussion Foyer of Canada Hall 1	
7:00 PM – 10:00 PM	Student Social Night Canadian Museum of Nature	Inuit Culture Night Trillium Ballroom	Canada C3 Documentary Ottawa Salon	Gala Banquet Canada Hall 1	

# STUDENT DAY PROGRAM

Early-career researchers are involved in projects that require cooperation and collaboration between Indigenous communities, researchers, and other stakeholders across Inuit Nunangat and Northern Canada. ArcticNet 2018 Student Day transcends research disciplines to provide a range of sessions that equip early-career researchers with the tools and skills they need to succeed in Arctic research and in their careers.

The theme for Student Day 2018 is '**Building the Capacity, Resilience, and Awareness of Early-Career Arctic Researchers**' and is brought to you in collaboration with the ArcticNet Student Association (ASA), the Association of Polar Early Career Scientists (APECS), the Permafrost Young Researchers Network (PYRN), and a dedicated group of student volunteers. Student Day will offer a range of plenaries, workshops, and panel discussions, as well as an elevator pitch competition and a networking/social evening at the Museum of Nature.

# MONDAY, DECEMBER 10<sup>TH</sup> 2018

The Shaw Centre, Ottawa

8:30 AM – 9:00 AM	<b>Student Day Welcoming Remarks</b> ArcticNet, ArcticNet Student Association Executive Committee (ASA), Association of Polar Early Career Scientists (APECS), and Permafrost Young Researchers Network (PYRN)	OTTAWA SALON
9:00 AM – 10:00 AM	<b>Competition</b> <b>ELEVATOR PITCHES</b>  <b>About:</b> Student Day participants will have the opportunity to promote their science by means of an Elevator Pitch. Contestants will have one minute and one slide to pitch their research project and pique the public's curiosity. Judges will award 1st, 2nd and 3rd place prizes to the top elevator pitches. Also, audience members will vote for a People's Choice Award.	OTTAWA SALON
10:00 AM – 10:30 AM	<b>Break</b>	
10:30 AM – 11:15 AM	<b>Plenary Presentation</b> <b>BEING AN EARLY CAREER ARCTIC RESEARCHER IN 2018</b>  Jean Holloway (PhD candidate at the University of Ottawa) Samuel Gagnon (PhD candidate at the Université Laval)  <b>About:</b> We have invited two of our peers on stage to share their journey as Arctic graduate students. Like many of us, they have been preparing themselves for careers in Arctic research. Being an Arctic researcher requires not only publishing results, but also the need to gain online communication skills, leadership and thoughtful community engagement. This plenary session will discuss how transferable skills can be acquired and nurtured through your studies and how these skills are a paramount part of graduate studies.	OTTAWA SALON
11:15 AM – 12:00 PM	<b>Plenary Panel</b> <b>NORTHERN RESEARCH AND RECONCILIATION: PERSPECTIVES AND ADVICE FOR EARLY CAREER RESEARCHERS</b>  Dr. Jennifer Provencher (Environment and Climate Change Canada) Dr. Robert Way (Queens University) Enooyaq Sudlovenick (University of Prince Edward Island) Dr. Scot Nickels (Director, Inuit Qaujisarvingat, ITK)  <b>About:</b> This panel discussion is a contribution to the conversation around reconciliation from the perspective of Indigenous and non-Indigenous northern researchers. The moderated conversation will explore panelists' perspectives on what role research can and should play toward reconciliation in Canada's north and will provide advice to early-career researchers on actions that they can take to further reconciliation through their research activities.	OTTAWA SALON

12:00 PM – 1:30 PM

Lunch

1:30 PM – 2:15 PM

Workshop

OTTAWA SALON

**BRIDGING NORTHERN AND SOUTHERN PERSPECTIVES ON ARCTIC RESEARCH PRIORITIES  
(part 1)**

**About:** Ikaarvik is a program that works with northern youth to identify community research priorities and address these issues through partnership with southern researchers.

Lots of people talk about improving the relationship between research and northern communities; we think connecting Arctic youth and southern students is the perfect place to start! Using Ikaarvik's work in Nunavut as an example, this workshop will facilitate connections between northern and southern early career researchers through the discussion of Arctic research priorities, engaging youth and improving the relationship between research and northern communities. In addition to the presentation, time will be provided for cross-cultural sharing and discussion. Come for the fun, stay for the life-changing insights!

1:30 PM – 2:15 PM

Workshop

ROOM 210

**SCIENCE COMMUNICATION AND COMMUNITY OUTREACH (part 1)**

Erin Macpherson (Let's Talk Science)

**About:** This session will introduce participants to the process of doing community outreach in Northern communities in a meaningful and culturally responsive way. Topics covered include educational contexts in Northern communities, strategies to engage communities/schools, learning theories, and interactive activity design.

1:30 PM – 2:15 PM

Panel

ROOM 212

**BEING A RESILIENT AND SUSTAINABLE RESEARCHER**

Dr. Carie Hoover (Dalhousie University)  
Dustin Whalen (Natural Resources Canada)  
Louis-Philippe Roy (Yukon Research Centre)  
Cassandra Debets (PhD candidate at University of Manitoba)

**About:** The discussion of achieving 'work-life balance' is one that is not isolated to careers or studies in Arctic research, but being an Arctic graduate student or researcher does have unique challenges in this age-old discussion. It is important that we have the tools and skills to help us recover from challenging workloads, and avoid burn out as to maintain ourselves for long careers. The goal of this panel is to bring diverse perspectives and experiences to the table to discuss advice for graduate students to be resilient researchers. We don't have all the answers but we'll share candidly with you our insights gained from our experiences.

2:15 PM – 3:00 PM	<p><b>Workshop</b></p> <p><b>BRIDGING NORTHERN AND SOUTHERN PERSPECTIVES ON ARCTIC RESEARCH PRIORITIES (part 2)</b></p> <p><b>About:</b> Ikaarvik is a program that works with northern youth to identify community research priorities and address these issues through partnership with southern researchers.</p> <p>Lots of people talk about improving the relationship between research and northern communities; we think connecting Arctic youth and southern students is the perfect place to start! Using Ikaarvik's work in Nunavut as an example, this workshop will facilitate connections between northern and southern early career researchers through the discussion of Arctic research priorities, engaging youth and improving the relationship between research and northern communities. In addition to the presentation, time will be provided for cross-cultural sharing and discussion. Come for the fun, stay for the life-changing insights!</p>	OTTAWA SALON
2:15 PM – 3:00 PM	<p><b>Workshop</b></p> <p><b>SCIENCE COMMUNICATION AND COMMUNITY OUTREACH (part 2)</b></p> <p><b>Erin Macpherson (Let's Talk Science)</b></p> <p><b>About:</b> This session will introduce participants to the process of doing community outreach in Northern communities in a meaningful and culturally responsive way. Topics covered include educational contexts in Northern communities, strategies to engage communities/schools, learning theories, and interactive activity design.</p>	ROOM 210
2:15 PM – 3:00 PM	<p><b>Presentation</b></p> <p><b>TOP TIPS FOR SUCCESSFUL GRANT WRITING</b></p> <p><b>Dr. Stephen Petersen (Assiniboine Park Zoo)</b>  <b>Dr. Mylene Riva (McGill University)</b></p> <p><b>About:</b> Research proposals and grant applications are an important aspect of Northern research. Clearly communicating your research for these submissions is key. Under the guidance of experienced scientists representing both natural and social sciences, this presentation will provide students with top tips in planning and preparing strong research proposals and applications according to their research interests and audiences.</p>	ROOM 212
3:00 PM – 3:30 PM <b>Break</b>		
3:30 PM – 4:15 PM	<p><b>Panel</b></p> <p><b>CAREERS IN ARCTIC RESEARCH</b></p> <p><b>Dr. Melissa Lafreniere (Queen's University)</b>  <b>Erin Abou-Abssi (Oceans North)</b>  <b>Jennifer Sokol (Polar Knowledge)</b></p>	OTTAWA SALON

Shannon MacPhee (DFO)

**About:** Career development is extremely important for early career researchers, but it is helpful to know what type of job you are interested in before you start to hone in and build skills. This panel will be a discussion of potential careers in Arctic Research from a group with diverse backgrounds. Whether it be government science, academia, or working for an NGO, there are many options. Our panelists will be discussing how they ended up in their current position, as well as providing some tips and tricks to help you end up there too!

3:30 PM – 4:15 PM

**Workshop**

**IMPROV FOR SCIENTISTS**

Dr. Monica Granados (Mitacs Canadian Science Policy Fellow)

Dr. Katie Pagnucco (John Abbott College)

**About:** Improvisational comedy can improve the practice of science. You learn to be spontaneous, to embrace failure, to effectively tell stories, to be a better listener and the importance of contributing to ideas. In this introductory workshop, we will introduce the fundamentals of improv through a series of guided group and partner exercises and directly link each fundamental element of improv to its application in the practice and communication of science.

ROOM 210

3:30 PM – 4:15 PM

**Panel**

**THE IMPORTANCE OF MENTORSHIP**

Dr. Jennifer Provencher (Environment and Climate Change Canada)

Dr. Robert Letcher (Environment and Climate Change Canada)

Dr. Jackie Dawson (UOttawa)

Alysa McCall (Polar Bears International)

Eric Loring (Inuit Tapiriit Kanatami)

**About:** As an early career researcher, your supervisor is there to support you and guide you through the graduate process but often there are other people who are foundational in your growth. This diverse panel will discuss the topic of mentorship and the important role that it plays. Who and what is a mentor? How is a mentor different from a supervisor? How do you find someone that is mentor fit for you?

ROOM 212

6:00 PM

**Social Night**

This year, the social night will be hosted at the Museum of Nature. This unique setting will be a fun place to network and enjoy the Arctic exhibition.

Canadian  
Museum of  
Nature



# TUESDAY, DECEMBER 11<sup>TH</sup> 2018

The Shaw Centre, Ottawa

8:30 AM – 9:15 AM

## Plenary Panel

OTTAWA SALON

### COMMUNITY COLLABORATIONS AND ENGAGEMENT WITH RESEARCH

Mia Otokiak (Youth Mentor for the Ikaarvik: Barriers to Bridges program)

Dr. Lisa Loseto (DFO)

Natasha Simonee (Former Mittimatalik HTO Manager and Pond Inlet, Nunavut Community Member) Marissa Mills (uOttawa student and Kluane First Nation (Burwash Landing, Yukon) Community Member)

**About:** Engagement with Indigenous communities is an important part of many Arctic research projects, but there is little training offered for early career researchers (ECRs) on how to conduct these types of activities. Short term projects and limited funding make meaningful engagement challenging. Who do you contact? What type of activities are best? We hope to provide some guidance for ECRs on engaging with Indigenous communities through the whole pipe-line of a research project - what to do before you start, how to engage communities during the project, and how to share your results. This panel will include perspectives from researchers and community members who will talk about successful engagement and best practices.

9:15 AM – 10:00 AM

## Presentation

OTTAWA SALON

### DATA MANAGEMENT ESSENTIALS

Chantel Ridsdale (Canadian Cryospheric Information Network/Polar Data Catalogue)

Gabrielle Alix (Canadian Cryospheric Information Network/Polar Data Catalogue)

**About:** Data management is a looming requirement in several nations around the world. Most, if not all, researchers are familiar with this eventuality, but many do not know how to best react to it. CCIN/PDC has worked closely with the Polar data community in Canada, and internationally, to develop guidelines based on stakeholder feedback as well as implementing data archiving for a number of Canadian national programs, including ArcticNet, and so we are well positioned to help others understand and implement them effectively. This presentation will help students and researchers understand why data management is important, what the best practices are, how best to undertake it, as well as address concerns the community has.

9:15 AM – 10:00 AM

## Workshop

ROOM 210

### COMMUNITY COLLABORATIONS AND ENGAGEMENT WITH RESEARCH

Mia Otokiak (Youth Mentor for the Ikaarvik: Barriers to Bridges program)

Dr. Lisa Loseto (DFO)

Natasha Simonee (Former Mittimatalik HTO Manager and Pond Inlet, Nunavut Community Member) Marissa Mills (uOttawa student and Kluane First Nation (Burwash Landing, Yukon) Community Member)

**About:** Engagement with Indigenous communities is an important part of many Arctic research projects, but that there is very little training offered for early career researchers (ECRs) on how to conduct these types of activities. This workshop will follow the panel and aims to provide some hands-on learning for ECRs on how to develop community engagement during their research projects. The students will be provided with scenarios and will work in groups supervised by an expert to come up with engagement strategies. We hope that the students will come away with some ideas that they can implement in their current or future projects.

9:15 AM – 10:00 AM

Presentation

ROOM 212

**AUTHORSHIP AND PEER-REVIEW: PUBLISHING, REJECTION, and SUCCESS**

Dr. Greg Henry (University of British Columbia)

Matthew Sanscartier (Carleton University)

**About:** The process of publishing papers can be intimidating for early career researchers. Many questions and concerns may arise about submitting manuscripts and the peer-review process. Come to this workshop to learn and talk about: What type of work gets you authorship, how to choose who is an author on a paper, how the peer-review process works, how to deal with rejection, how to be a good reviewer, open-access journals, and more!

10:00 AM – 10:30 AM

Break

10:30 AM – 11:15 AM

Presentation

OTTAWA SALON

**STUDENTS ON ICE: THE POLAR CLASSROOM**

Caitlyn Baikie (SOI Arctic Youth and Partnership Program Manager)

**About:** Students on Ice is an award-winning organization offering unique educational expeditions to the Arctic and the Antarctic. Our mandate is to educate the world's youth about the importance of the Polar Regions, support their continued growth and inspire and catalyze initiatives that contribute to global sustainability. During this session, you will learn about experiential education pedagogies and why the Arctic is the greatest classroom on Earth. We have developed our approach over the years that respectfully engages Inuit youth, community members, and organizations to develop and deliver life changing expeditions for youth from a diverse set of backgrounds.

10:30 AM – 11:15 AM

Presentation

ROOM 210

**TOOLS IN ARCTIC RESEARCH: SATELLITES, UAVS, and SHIPS**

Eleanor Bash (University of Calgary)

Dr. Louis Fortier (Université Laval)

Dr. Robert Fraser (Natural Resources Canada)

**About:** Research in the Arctic can be limited by its remoteness and its harshness. Some areas of the Arctic are very hard to study, either because they are impossible or difficult to reach, or because of the cost of reaching them. Scientists therefore use tools to allow them to study different aspects of the Arctic landscape. Learn more about how satellites, planes, drones and ships are used to study the Arctic.

10:30 AM - 11:15 AM

Presentation

ROOM 212

#SOCIALMEDIA and #YOURRESEARCH

Jean Holloway (University of Ottawa)

Shannon MacPhee (Fisheries and Oceans Canada; Beaufort Sea Beluga)

Dr. Isla Myers-Smith (University of Edinburgh; Team Shrub)

**About:** Science communication is about sharing scientific research online with other scientists and the public, and social media represent an efficient and easy platform for scientists to communicate their research and gain attention. Social media can also be used in other ways for science; it is a great resource for researchers to learn about studies and opportunities related to their field of interest, and, in the context of Arctic research, it can be a useful tool to connect with northern community members. This workshop is an opportunity to learn about different ways of using social media for research.

11:15 AM

Closing Remarks and Award Ceremony

OTTAWA SALON

ASA-APECS MENTOR AWARD AND ELEVATOR PITCH AWARD CEREMONY

# SIDE MEETINGS PROGRAM

MONDAY, DECEMBER 10<sup>TH</sup> 2018

The Shaw Centre, Ottawa

8:00 AM – 9:00 PM	<p><b>Private, by invitation only</b></p> <p>Table top exercise for managing One Health emergencies in the Arctic: An Arctic Council Sustainable Development Working Group initiative UNIVERSITY OF SASKATCHEWAN</p>	ROOM 106
1:00 PM – 5:00 PM	<p><b>Open, all are welcome</b></p> <p>T-MOSaIC Open Workshop UNIVERSITÉ LAVAL</p> <p>T-MOSaIC (Terrestrial Multidisciplinary distributed Observatories for the Study of Arctic Connections: <a href="http://www.T-MOSaIC.com">www.T-MOSaIC.com</a>) is an IASC circumpolar program to examine the implications of the changing Arctic Ocean sea ice and climate on terrestrial ecosystems, geosystems and human systems. The work will take place in parallel with the largescale oceanographic program MOSaIC. This third workshop will focus on implementation in 2019-20, and all interested researchers are welcome to attend.</p>	ROOM 102
1:30 PM – 4:30 PM	<p><b>Private, by invitation only</b></p> <p>PDMC Meeting CCIN/PDC</p>	ROOM 100
5:00 PM – 6:30 PM	<p><b>Open, all are welcome</b></p> <p>POLAR 101 POLAR KNOWLEDGE CANADA</p> <p>Polar Knowledge Canada (POLAR) will be hosting an open session as part of the 2018 ArcticNet Annual Scientific Meeting to provide an overview of POLAR's programing and partnership opportunities. The event will consist of presentations, and open discussion and Q&amp;A's with POLAR staff. Participants will be provided with an details of POLAR's S&amp;T activities, information on how to partner with POLAR and an update on the Canadian High Arctic Research station in Cambridge Bay, Nunavut. This will be a 90 minute session, open to all ASM participants.</p>	ROOM 212

# TUESDAY, DECEMBER 11<sup>TH</sup> 2018

The Shaw Centre, Ottawa

8:00 AM – 12:30 PM	<p><b>Private, by invitation only</b></p> <p>Table top exercise for managing One Health emergencies in the Arctic: An Arctic Council Sustainable Development Working Group initiative UNIVERSITY OF SASKATCHEWAN</p>	ROOM 107
8:00 AM – 4:00 PM	<p><b>Private, by invitation only</b></p> <p>Nunavut Fisheries Association's Annual Research Meeting NUNAVUT FISHERIES ASSOCIATION (NFA)</p>	ROOM 104
8:30 AM – 12:00 PM	<p><b>Open, all are welcome</b></p> <p>Indigenous Community-Based Climate Monitoring INDIGENOUS COMMUNITY-BASED CLIMATE MONITORING PROGRAM – CIRNAC</p> <p>The Community-Based Climate Monitoring Program at Crown Indigenous-Relations and Northern Affairs Canada would like to provide a networking opportunity for Indigenous People and collaborators to gather and share ideas, strategies and stories of Indigenous community-based climate monitoring efforts. The intention is to host an open-format session that would allow for introductions and the possibility to break into smaller thematic groups based on region, climate monitoring priority, or other area of focus such as: capacity, data management and collaboration.</p>	ROOM 102
9:00 AM – 12:00 PM	<p><b>Open, all are welcome</b></p> <p>CNNRO AGM CNNRO</p> <p>The Canadian Network of Northern Research Operators (CNNRO, <a href="http://cnnro.ca">cnnro.ca</a>) is holding its AGM on Tuesday, December 11th, from 9h00 to 12h00.</p> <p>The Canadian Network of Northern Research Operators (CNNRO) is a network of research support facilities providing specialized technical services to academic, government, private and international scientific research sectors. Our member facilities provide the know-how and infrastructure that make research possible in our nation's Arctic and sub-Arctic regions. Our network is at the cutting edge of knowledge creation in northern Canada. CNNRO member facilities range from long-established research institutes and observatories, to seasonal field stations and un-staffed remote monitoring installations. We are widespread, representing every major ecological region in Canada's North. Our Annual General Meeting is for members but is open to all.</p>	ROOM 203
9:00 AM – 12:00 PM	<p><b>Open, all are welcome</b></p> <p>SIKU.org workshop: creating a social media network by and for Inuit. ARCTIC EIDER SOCIETY</p> <p>Substantial progress has been made developing the SIKU.org online platform and mobile app, and beta testing with project partners and northern communities is ongoing. This workshop will</p>	ROOM 201

bring together current and prospective project development partners to learn about features in progress, share lessons learned, and contribute to ongoing priorities for new features, tools and services. Consultation on approaches to data management and intellectual property towards defining a Terms of Reference and Privacy Policy that facilitate Indigenous self-determination and stewardship of the platform will also be discussed. All are welcome; participation by Indigenous organizations and community representatives is particularly encouraged.

10:30 AM – 12:00 PM

Open, all are welcome

ROOM 204

Collaboration on community-monitoring programs in the Territories.  
TUKTOYAKTUK COMMUNITY CORPORATION

The objective of this meeting will be to discuss the development of an inventory, lessons learned and best practices for community-based monitoring in the region.

11:00 AM – 12:00 PM

Open, all are welcome

ROOM 211

Environmental Petitions and You: Asking Questions and Getting Answers - the Environmental Petitions Process  
COMMISSIONER OF THE ENVIRONMENT AND SUSTAINABLE DEVELOPMENT

What are Environmental Petitions? The presentation will outline the Environmental Petitions process managed by the Federal Commissioner of the Environment and Sustainable Development (CESD). The federal environmental petitions process allows Canadian residents to ask Federal Ministers to respond to questions or suggestions for action on environmental issues that concern them. The presentation will provide the background and examples of environmental petitions along with tips for drafting and submitting a petition.

4:00 PM – 6:00 PM

Open, all are welcome

ROOM 107

Pikialasorsuaq Commission  
INUIT CIRCUMPOLAR COUNCIL

The Pikialasorsuaq Commission recommended Inuit led management and monitoring of the Pikialasorsuaq (North water polynya). This meeting will bring communities, Inuit governance, academics, policy makers together to discuss the advancement of the Commission recommendations.

## WEDNESDAY, DECEMBER 12<sup>TH</sup> 2018

The Shaw Centre, Ottawa

1:30 PM – 4:30 PM

Open, all are welcome

ROOM 104

Nunavut General Monitoring Plan (NGMP)  
CIRNAC

To bring together researchers who have experience running community-based monitoring projects to discuss lessons learned and best practices.

## THURSDAY, DECEMBER 13<sup>TH</sup> 2018

The Shaw Centre, Ottawa

8:30 PM – 1:00 PM	<b>Private, by invitation only</b> Natural Resources Canada - Impact Canada Off-Diesel Initiative Engagement Session NATURAL RESOURCES CANADA	ROOM 104
5:00 PM – 7:00 PM	<b>Private, by invitation only</b> Towards a Sustainable Fishery for Nunavummiut (TSFN) Annual General Meeting QUEEN'S UNIVERSITY	ROOM 107

## FRIDAY, DECEMBER 14<sup>TH</sup> 2018

The Shaw Centre, Ottawa

1:00 PM – 3:30 PM	<b>Private, by invitation only</b> Nunataryuk TAKUVIK, UNIVERSITÉ LAVAL	ROOM 100
-------------------	---	----------

# PLENARY PROGRAM

TUESDAY, DECEMBER 11, 2018

1:30 PM – 3:00 PM

*Chair: Leah Braithwaite – Executive Director, ArcticNet*

OTTAWA SALON

1:30 PM – 1:40 PM TUE. DEC. 11	Conference Welcome <b>LEAH BRAITHWAITE</b> – Executive Director, ArcticNet
1:40 PM – 1:50 PM TUE. DEC. 11	Opening Remarks <b>NATAN OBED</b> – President Inuit Tapiriit Kanatami
1:50 PM – 2:00 PM TUE. DEC. 11	Canada in the Anthropocene <b>DR. ALAN MACEACHERN</b> – Professor – Department of History, University of Western Ontario
2:00 PM – 2:20 PM TUE. DEC. 11	Arctic Futures – Generating Scenarios for 2050 <b>DR. AMY L. LOVECRAFT</b> – Professor and Department Chair – Political Science, University of Alaska Fairbanks
2:20 PM – 2:40 PM TUE. DEC. 11	Emerging Northern Fisheries and Their Research Needs <b>MR. ALASTAIR O’RIELLY</b> – Executive Director, Northern Coalition Corporation Alliance of Indigenous-owned Fisheries in the Eastern Arctic and Labrador
2:40 PM – 3:00 PM TUE. DEC. 11	Canada C3 Documentary – Sneak Peak

WEDNESDAY, DECEMBER 12, 2018

8:30 AM – 10:00 AM

*Chair: Leah Braithwaite – Executive Director, ArcticNet*

OTTAWA SALON

8:30 AM – 8:40 AM WED. DEC. 12	Opening Remarks <b>LEAH BRAITHWAITE</b> – Executive Director, ArcticNet
8:40 AM – 9:00 AM WED. DEC. 12	Innovative Technologies for the Northern Environment and Human Health <b>DR. MARTIN FORTIER</b> – Executive Director – Sentinel North Canada First Research Excellence Fund, Université Laval
9:00 AM – 9:40 AM WED. DEC. 12	Panel Discussion   <b>Pikialasoruaq: Stewardship of the North Water Polynya</b> <i>Moderator: Lisa Qiuqqi Koperqualuk, Vice-President Inuit Circumpolar Council Canada</i>  Members: <b>OKALIK EEGEESIAK, LOUIS FORTIER, SUZANNE LALONDE, PAUL CROWLEY, NADIA BOUFFARD</b>
9:40 AM – 10:00 AM WED. DEC. 12	The W. Garfield Weston Foundation: Presentation of the \$100,000 Weston Family Prize for Lifetime Achievement in Northern Research <b>THE W. GARFIELD WESTON FOUNDATION</b> <b>ASSOCIATION OF CANADIAN UNIVERSITIES FOR NORTHERN STUDIES</b>



## THURSDAY, DECEMBER 14, 2018

8:30 AM – 10:00 AM

Chair: Leah Braithwaite – Executive Director, ArcticNet

OTTAWA SALON

- |                                    |   |
|------------------------------------|---|
| 8:30 AM – 8:35 AM<br>THU. DEC. 13  | Opening Remarks<br>LEAH BRAITHWAITE – Executive Director, ArcticNet   |
| 8:35 AM – 8:55 AM<br>THU. DEC. 13  | Could the 2012 Extreme Arctic sea ice extent minimum have happened in an unperturbed climate?<br>DR. FRANCIS ZWIERS – Director – Pacific Climate Impacts Consortium (PCIC), University of Victoria  |
| 8:55 AM – 9:15 AM<br>THU. DEC. 13  | Emerging Infectious Diseases in Terrestrial Arctic Wildlife: Improving Detection, Response and Communication<br>DR. SUSAN KUTZ – Professor – Department of Ecosystem and Public Health, Faculty of Veterinary Medicine, University of Calgary |
| 9:15 AM – 9:35 AM<br>THU. DEC. 13  | Ancient and Urgent: Arctic Climate Change and the Destruction of the Archaeological Record<br>DR. MAX FRIESEN – Professor – Department of Anthropology, University of Toronto   |
| 9:35 AM – 9:55 AM<br>THU. DEC. 13  | Circumpolar Innovation and Reconciliation<br>DR. KENNETH COATES – Professor, Graduate School of Public Policy – Canada Research Chair in Regional Innovation, University of Saskatchewan  |
| 9:55 AM – 10:00 AM<br>THU. DEC. 13 | Video Excerpt : <i>Ms. Scientist</i><br>LEAH BRAITHWAITE – Executive Director, ArcticNet and BRANDY YANCHYK – Producer/Director/Writer  |

## FRIDAY, DECEMBER 15, 2018

10:30 AM – 12:00 PM

Chair: Leah Braithwaite – Executive Director, ArcticNet

OTTAWA SALON

- |                                     |  |
|-------------------------------------|--|
| 10:30 AM – 10:40 AM<br>FRI. DEC. 14 | Opening Remarks<br>LEAH BRAITHWAITE – Executive Director, ArcticNet  |
| 10:40 AM – 11:00 AM<br>FRI. DEC. 14 | Reflections on the relationship between Arctic Science and International Policy<br>AMBASSADOR THOMAS WINKLER – Ambassador to Canada from the Kingdom of Denmark  |
| 11:00 AM – 11:20 AM<br>FRI. DEC. 14 | Impacts of a Changing Climate on Marine Wildlife and Communities in the Wester Arctic<br>DR. LISA LOSETO – Fisheries and Oceans Canada and Inuit Organization Representative                                     |
| 11:20 AM – 11:40 AM<br>FRI. DEC. 14 | The Greening of the Arctic<br>DR. ISLA MYERS-SMITH – Chancellor's Fellow, School of GeoSciences, University of Edinburgh   |
| 11:40 AM – 12:00 PM<br>FRI. DEC. 14 | ArcticNet – What could be next?<br>DRS. PHIL ARCHAMBAULT, JACKIE DAWSON, LOUIS FORTIER – Scientific co-Directors & Scientific Director, ArcticNet<br>MR. ANDREW DUNFORD – Chair, Arctic Inuit Advisory Committee |
| 12:00 PM<br>FRI. DEC. 14            | Closing Remarks<br>LEAH BRAITHWAITE – Executive Director, ArcticNet  |

# TOPICAL SESSIONS PROGRAM

TUESDAY, DECEMBER 11, 2018

3:30 PM – 5:00 PM

9 Parallel Sessions

<b>POL03.</b>	<b>Arctic Governance and the Private Sector: Challenges and Opportunities</b>	<b>ROOM 201</b>
	<i>Chairs: Mathieu Landriault and Pierre-Louis Têtu</i>	
3:30 PM – 3:45 PM TUE. DEC. 11	Corporate social responsibility standards in the Arctic cruise tourism industry? The role of the Association of Arctic Expedition Cruise Operators in sustainable tourism governance <b>PIERRE-LOUIS TÊTU</b>	
3:45 PM – 4:00 PM TUE. DEC. 11	What role can telecommunications companies play in the development of connectivity in the Arctic? <b>MICHAEL DELAUNAY</b>	
4:00 PM – 4:15 PM TUE. DEC. 11	Renewable capacity limits: why they are implemented and how they impact isolated communities <b>MICHAEL ROSS</b>	
4:15 PM – 4:30 PM TUE. DEC. 11	Regulating maritime occupational health and safety in the Canadian Arctic Gateway <b>DESAI SHAN</b>	
4:30 PM – 4:45 PM TUE. DEC. 11	INGO Legitimacy in the Arctic: The WWF as a Rightful Actor in Arctic Governance <b>DANITA CATHERINE BURKE</b>	
<b>TER04.</b>	<b>Coastal Dynamics in a Changing Climate</b>	<b>ROOM 202</b>
	<i>Chairs: Dustin Whalen and Hugues Lantuit</i>	
3:30 PM – 3:45 PM TUE. DEC. 11	The Complexities of Coastal Retreat in a Permafrost Environment: A long-term geophysical study <b>BRIAN MOORMAN</b>	
3:45 PM – 4:00 PM TUE. DEC. 11	Monitoring the Lena River spring breakup flood in 2013 with TerraSAR-X imagery and the TanDEM-X Digital Elevation Model <b>ACHIM ROTH</b>	
4:00 PM – 4:15 PM TUE. DEC. 11	Modelling the changing storm surge regime as a result of sea ice decline in the Canadian Beaufort Sea <b>MATTHEW ASPLIN</b>	
4:15 PM – 4:30 PM TUE. DEC. 11	Coastal Dynamics in Tuktoyaktuk – complex issues, complex impacts and complex solutions <b>DUSTIN WHALEN</b>	

4:30 PM – 4:45 PM  
TUE. DEC. 11 | Hydrographic and biogeochemical conditions in northeastern coastal James Bay and southeastern Hudson Bay during winter and summer of 2016-2017  
ALESSIA GUZZI

4:45 PM – 5:00 PM  
TUE. DEC. 11 | Rapid CO2 release from eroding permafrost coasts and nearshore waters  
GEORGE TANSKI

**IHEA07. Meeting the Challenge – Understanding and Taking Action to Promote Food Security in the Arctic** **ROOM 203**

*Chairs: Chris Furgal, Sonia Wesche and James Ford*

3:30 PM – 3:45 PM  
TUE. DEC. 11 | Systematic review of factors related to food (in)security status in Nunavik, Quebec  
BRITTANY CURRY-SHARPLES

3:45 PM – 4:00 PM  
TUE. DEC. 11 | 'Feeding our families; that's what we have been doing for centuries': Inuit women's sharing practices and strategies  
MAGALIE QUINTAL-MARINEAU

4:00 PM – 4:15 PM  
TUE. DEC. 11 | The Green Iglu: The social, health and economic impacts of a greenhouse in Naujaat and Arviat Nunavut.  
JULIE ROBERTSON

4:15 PM – 4:30 PM  
TUE. DEC. 11 | Developing key food security skills among Inuit youth: the experience of a pilot project in Nunatsiavut  
KRISTEEN MCTAVICH

**MAR05. Icebergs and Ice Islands: Calving, Drift and Decay Processes** **ROOM 204**

*Chairs: Wesley Van Wychen and Derek Mueller*

3:30 PM – 3:45 PM  
TUE. DEC. 11 | The fate of Petermann ice islands: Using the CI2D3 Database to investigate size distributions and meltwater dispersal after Petermann Glacier calving events  
ANNA CRAWFORD

3:45 PM – 4:00 PM  
TUE. DEC. 11 | Modelling Greenland icebergs: Their pathways as solid ice and meltwater  
INGE DESCHEPPER

4:00 PM – 4:15 PM  
TUE. DEC. 11 | Iceberg fracture processes and modelling  
ROCKY TAYLOR

4:15 PM – 4:30 PM  
TUE. DEC. 11 | Short-term iceberg drift forecasting – theoretical comparison of the deterministic and statistical-plus approaches  
DAVID FISSEL

4:30 PM – 4:45 PM  
TUE. DEC. 11 | Measurement of sea ice, icebergs and ice islands topography using satellite imagery  
IGOR ZAKHAROV

**POL06. Identifying and Improving Weather, Water, and Ice Information Services for Safe Arctic Travel** **ROOM 209**

*Chairs: Gita Ljubicic and Jackie Dawson*

3:30 PM – 3:45 PM TUE. DEC. 11	Understanding impacts of weather, climate, and climate change on the physical, cultural and social environments in the North CAROLYN MARSHALL
3:45 PM – 4:00 PM TUE. DEC. 11	Iglulingmiut weather and ice forecasting THEO IKUMMAQ
4:00 PM – 4:15 PM TUE. DEC. 11	Safe Passage: A Polar Knowledge Canada Project on sea ice to improve Arctic marine transportation RICHARD DEWEY
4:15 PM – 4:30 PM TUE. DEC. 11	SmartICE: application of a social enterprise model to the delivery of sea-ice monitoring and information services ANDREW ARREAK
4:30 PM – 4:45 PM TUE. DEC. 11	Crowd-sourced bathymetry in Northern Canada JULIEN DESROCHERS
4:45 PM – 5:00 PM TUE. DEC. 11	Building a weather-ready Alaska CARVEN SCOTT

## TECH01.

### IEEE Arctic and Northern Ocean Forum – Instrumentation and Autonomous Technologies for the North

ROOM 210

*Chairs: Philip Ferguson and Ryan Galley*

3:30 PM – 3:45 PM TUE. DEC. 11	Icing Protection Systems for UAVs in the Arctic RICHARD HANN
3:45 PM – 4:00 PM TUE. DEC. 11	A multi-vehicle drone testbed for space systems and remote sensing verification AMIN YAHYAABADI
4:00 PM – 4:15 PM TUE. DEC. 11	Use of automated systems for the study of oceanic dimethylsulfide dynamics in ice-covered and ice-free waters of the Arctic JOANIE ST-ONGE
4:15 PM – 4:30 PM TUE. DEC. 11	IceCube: A nanosatellite concept for Canadian Arctic monitoring JAIME CAMPOS
4:30 PM – 4:45 PM TUE. DEC. 11	On the autonomous measurement of snow density FÉLIX LÉVESQUE-DESROSIERS

## TERO1.

### Arctic Ecosystems and Wildlife

ROOM 211

*Chairs: Jesper Bruun Mosbacher and Jean-Pierre Desforges*

3:30 PM – 3:45 PM TUE. DEC. 11	Environmental determinants of adult survival in migratory tundra caribou BARBARA VUILLAUME
3:45 PM – 4:00 PM TUE. DEC. 11	Human disturbance effects and their relative importance compared to natural factors in explaining migratory caribou survival SABRINA PLANTE

- 4:00 PM – 4:15 PM  
TUE. DEC. 11 | Hair element profile as a non-invasive indicator of wildlife population demographics  
JESPER BRUUN MOSBACHER
- 4:15 PM – 4:30 PM  
TUE. DEC. 11 | The influence of changing watersheds on the demographics of traditionally-harvested Arctic muskrats  
JEREMY BRAMMER
- 4:30 PM – 4:45 PM  
TUE. DEC. 11 | Listening to the songs of the Arctic: large scale monitoring of avian phenology  
NICOLAS LECOMTE

**KM08. Science Education, Outreach and Communication in the North by Early Career Researchers (ECRs): Success Stories and Challenges** **ROOM 212**

*Chairs: Catherine Girard, Sophie Dufour-Beauséjour and Gwyneth MacMillan*

- 3:30 PM – 3:45 PM  
TUE. DEC. 11 | Science Outreach and Youth Engagement in an innovative On-the-Land Camp in the NWT  
CAROLYN GIBSON
- 3:45 PM – 4:00 PM  
TUE. DEC. 11 | Amplifying voices: Recordings from a radio activity about the land and climate change in Kangiqsujuaq, Nunavik  
SOPHIE DUFOUR-BEAUSÉJOUR
- 4:00 PM – 4:15 PM  
TUE. DEC. 11 | Stories from Tłı̄chǫ lands: Development of a successful Northern partnership from an early career researcher's perspective  
JAMES TELFORD
- 4:15 PM – 4:30 PM  
TUE. DEC. 11 | Partnership with Vuntut Gwitchin First Nation for the Old Crow solar project  
MICHAEL ROSS
- 4:30 PM – 4:45 PM  
TUE. DEC. 11 | Sharing tea in the field: Storytelling and trust-building, the hopes of research in the North  
SAMANTHA MCBETH
- 4:45 PM – 5:00 PM  
TUE. DEC. 11 | Visualizing changing oceans: Inuit knowledge and participatory video in Panniqtuuq, Nunavut  
NATALIE BAIRD
- 5:00 PM – 5:15 PM  
TUE. DEC. 11 | Sentinel North International Arctic Field Schools: a transdisciplinary and multicultural experience fostering leadership and innovation  
MARIE-FRANCE GÉVRY

**POL10. Out of the Cold: The Arctic as a Hotspot of International Politics - Canadian and European Practitioners' Perspectives** **ROOM 102**

*Chairs: Kristin Bartenstein and Daniel-Erasmus Khan*

- 3:30 PM – 3:45 PM  
TUE. DEC. 11 | RAMIN MOSCHTAGHI  
Head of the Department of Science and Economy of the German Embassy in Canada
- 3:45 PM – 4:00 PM  
TUE. DEC. 11 | STEFANO FANTARONI  
First Counsellor and Head of the Section of Political and Public Affairs (ad interim)
- 4:00 PM – 4:15 PM  
TUE. DEC. 11 | ROBERT KADAS  
Deputy Director and Principal Arctic Council Advisor to Canada's Senior Arctic Official

**TER10. United Nations Environmental Program Rapid Response Assessment on Coastal ROOM 201**

**Permafrost**

*Chairs: Scott Dallimore, Christopher Burn and Pippa Seccombe-Hett*

- 10:30 AM – 10:45 AM | Coastal and offshore permafrost in the southern Beaufort Sea- state of knowledge and appraisal of research needs  
WED. DEC. 12 | SCOTT DALLIMORE
- 10:45 AM – 11:00 AM | UNEP coastal permafrost RRA: research agendas for the terrestrial zone  
WED. DEC. 12 | CHRISTOPHER BURN
- 11:00 AM – 11:15 AM | Permafrost (research) in Canada 2018, a synthesis of observed change  
WED. DEC. 12 | NIELS WEISS
- 11:15 AM – 11:30 AM | Implications of permafrost decay on public infrastructure in the Northwest Territories  
WED. DEC. 12 | SARA BROWN
- 11:30 AM – 11:45 AM | A Mayor’s assessment of a community threatened by coastal erosion  
WED. DEC. 12 | MERVEN GRUBEN
- 11:45 AM – 12:00 PM | Introduction to the United Nations Environment Programme Coastal Permafrost Rapid Response Assessment  
WED. DEC. 12 | TIINA KURVITS

**IHEA09. One Health in the North ROOM 202**

*Chairs: Emily Jenkins and Patrick Leighton*

- 10:30 AM – 10:45 AM | Prevalence of Toxoplasma gondii in beluga and narwhal in Nunavut, Canada, and their potential role in foodborne transmission  
WED. DEC. 12 | BRENT DIXON
- 10:45 AM – 11:00 AM | Infection of eastern Canadian seals with the zoonotic protozoan parasites Toxoplasma, Neospora, and Sarcocystis  
WED. DEC. 12 | SARAH REILING
- 11:00 AM – 11:15 AM | Clams as a source of Toxoplasma gondii in Iqaluit, Nunavut  
WED. DEC. 12 | REBECCA FUNG
- 11:15 AM – 11:30 AM | Toxoplasma gondii and other zoonotic endoparasites in foxes and lynx in Arctic and Subarctic regions of Québec, Canada  
WED. DEC. 12 | ÉMILIE BOUCHARD
- 11:30 AM – 11:45 AM | Role of the nest flea, Ceratophyllus vagabundus vagabundus, as a potential bridge vector for Bartonella henselae transmission between nesting geese and arctic foxes, Vulpes lagopus, in Nunavut, Canada  
WED. DEC. 12 | KAYLA BUHLER
- 11:45 AM – 12:00 PM | Practices to ensure animal welfare in Sámi reindeer husbandry families in Nordland, Norway  
WED. DEC. 12 | MAJKEN PAULSEN

**IHEA07.****Meeting the Challenge – Understanding and Taking Action to Promote Food Security in the Arctic****ROOM 203***Chairs: Chris Furgal, Sonia Wesche and James Ford*

- 10:30 AM – 10:45 AM  
WED. DEC. 12 | Assumptions in the delivery and analysis of a common tool used to assess Inuit food security and the implications on understanding for this important public health issue in the North  
REBECCA MARTIN
- 10:45 AM – 11:00 AM  
WED. DEC. 12 | The role of key characteristics across scales in Inuit household food security status  
CHRIS FURGAL
- 11:00 AM – 11:15 AM  
WED. DEC. 12 | Food visioning for the future: A methodological approach to strategic planning with Arctic communities  
MELANIE FLYNN
- 11:15 AM – 11:30 AM  
WED. DEC. 12 | Collaborative research in the Inuvialuit Settlement Region (Western Canadian Arctic): Building the evidence-base for an Inuit Food Security Strategy  
SONIA WESCHE
- 11:30 AM – 11:45 AM  
WED. DEC. 12 | Understanding food, energy and water systems on subsistence activities to improve country food security in northern Indigenous communities: a new paradigm?  
VINAY RAJDEV

**MAR02.****Arctic Marine Mammals****ROOM 204***Chairs: Lisa Loseto and Steve Ferguson*

- 10:30 AM – 10:45 AM  
WED. DEC. 12 | A review of killer whale (*Orcinus orca*) ecology in a changing Canadian Arctic: research priorities and future directions  
KYLE LEFORT
- 10:45 AM – 11:00 AM  
WED. DEC. 12 | Trace element and stable isotope analysis elucidate stock structure in a narwhal (*Monodon monoceros*) population with no genetic substructure  
CORTNEY WATT
- 11:00 AM – 11:15 AM  
WED. DEC. 12 | Drivers of seasonal changes in the body condition of polar bears across Nunavut, Canada  
MELISSA GALICIA
- 11:15 AM – 11:30 AM  
WED. DEC. 12 | Developing an Indicator: Understanding variability and trends of beluga whale body condition and influence of environmental drivers  
KATHLEEN MACMILLAN
- 11:30 AM – 11:45 AM  
WED. DEC. 12 | Genomic tools to enable non-invasive monitoring of polar bears  
EVELYN JENSEN

**POL07.****Knowledge to Decision and Policy-Making: Approaches of Arctic Nations****ROOM 209***Chairs: Brendan Kelly, Leah Braithwaite and Amy Lauren Lovcraft*

- 10:30 AM – 10:45 AM  
WED. DEC. 12 | THOMAS WINKLER  
Ambassador of the Kingdom of Denmark to Canada

10:45 AM – 11:00 AM WED. DEC. 12	SEARCH and US approaches to Navigating the New Arctic <b>BRENDAN KELLY</b>
11:00 AM – 11:15 AM WED. DEC. 12	Co-operatives, equity-aware policy, and intermediaries: Factors in renewable energy adoption in Alaska with implications for Nunavut <b>OANA SPINU</b>
11:15 AM – 11:30 AM WED. DEC. 12	Understanding the networked structure of Arctic scientific research: The evolution of a Canadian Network of Centres of Excellence <b>ASHLEE-ANN PIGFORD</b>
11:30 AM – 11:45 AM WED. DEC. 12	Building knowledge and capacity in the North: Is research addressing northern priorities? <b>ALISON PERRIN</b>
11:45 AM – 12:00 PM WED. DEC. 12	Observations and Indigenous Knowledge: The Value of Multiple Evidence Based Approach to Arctic Science Production <b>SAM NICHOLS</b>

## TERO2.

### Arctic Freshwater Systems

ROOM 210

*Chairs: Yohanna Klanten, João Canário, Warwick F. Vincent and Diogo Folhas*

10:30 AM – 10:45 AM WED. DEC. 12	Methane cycling archives from warming Arctic lakes: Retrieving the genomic blueprints of ancient microbes <b>ALEXANDRA ROUILLARD</b>
10:45 AM – 11:00 AM WED. DEC. 12	Large winter increases of arsenic in surface waters of small subarctic lakes impacted by legacy mining pollution near Yellowknife, NT <b>MIKE PALMER</b>
11:00 AM – 11:15 AM WED. DEC. 12	Formation and demise of an icing-dammed proglacial lake on Bylot Island, Nunavut, Canada <b>MICHELLE BLADE</b>
11:15 AM – 11:30 AM WED. DEC. 12	Developing a novel snow observing system for improving the understanding and prediction of climate, hydrology, permafrost and ecology <b>PHILIP MARSH</b>
11:30 AM – 11:45 AM WED. DEC. 12	Tracking the extent and magnitude of the 2018 spring flood in the Peace-Athabasca Delta (Canada) using water isotope tracers <b>CASEY REMMER</b>

## TERO1.

### Arctic Ecosystems and Wildlife

ROOM 211

*Chairs: Jesper Bruun Mosbacher and Jean-Pierre Desforges*

10:30 AM – 10:45 AM WED. DEC. 12	Wildlife research at Canadian Forces Station Alert, Ellesmere Island <b>DOMINIQUE BERTEAUX</b>
10:45 AM – 11:00 AM WED. DEC. 12	Boots on the Ground - traditional knowledge caribou monitoring program <b>TYANNA STEINWAND</b>



- 11:00 AM – 11:15 AM  
WED. DEC. 12 | How much sampling effort is required to obtain less biased and more precise indexes of predator activity in tundra ecosystems?  
INES KHEDHRI
- 11:15 AM – 11:30 AM  
WED. DEC. 12 | Examining the structure of the Hudson Bay polar bear subpopulations: Do the current boundaries contribute to effective harvest management?  
JOSEPH NORTHRUP
- 11:30 AM – 11:45 AM  
WED. DEC. 12 | Examining the impacts of the George River Caribou Herd hunting ban on northern Labrador Inuit: An integrated resource management perspective.  
JASON DICKER

## MAR08.

### The Greater Hudson Bay Marine Region

ROOM 212

*Chairs: Lauren Candlish and Zou Zou Kuzyk*

- 10:30 AM – 10:45 AM  
WED. DEC. 12 | The Hudson Bay integrated regional impact study (IRIS) and future research perspectives  
ZOU ZOU KUZYK
- 10:45 AM – 11:00 AM  
WED. DEC. 12 | 1981 to 2070: An analysis of climate change's effect on 90 years of simulated, regulated ensemble discharge to Hudson Bay  
ANDREW TEFS
- 11:00 AM – 11:15 AM  
WED. DEC. 12 | A carbon budget for Hudson Bay  
DAVID CAPELLE
- 11:15 AM – 11:30 AM  
WED. DEC. 12 | Mercury and methylmercury mass budget in the Hudson Bay system: an update  
KATHLEEN MUNSON
- 11:30 AM – 11:45 AM  
WED. DEC. 12 | Stable population size in the face of a novel predator - why polar bear predation isn't driving declines in common eider populations  
CHRISTINA SEMENIUK
- 11:45 AM – 12:00 PM  
WED. DEC. 12 | Creation of the Hudson Bay Consortium and outcomes of the 2018 Hudson Bay Summit  
JOEL HEATH

## POL08.

### Managing the Social and Ecological Impacts of Marine Vessel Traffic in the Arctic ROOM 102

*Chairs: Natalie Carter and William Halliday*

- 10:30 AM – 10:45 AM  
WED. DEC. 12 | Arctic Corridors and Northern Voices: Working together to reduce the social and ecological impacts of increasing marine vessel traffic in the Canadian Arctic  
JACKIE DAWSON
- 10:45 AM – 11:00 AM  
WED. DEC. 12 | Incorporating Salluit community voices in Arctic marine corridor management  
KAYLA GREYDANUS
- 11:00 AM – 11:15 AM  
WED. DEC. 12 | Bridging Arctic marine shipping concerns and recommendations with management and policy  
MELISSA NACKE

11:15 AM – 11:30 AM WED. DEC. 12	Managing acoustic impacts on marine mammals in the western Canadian Arctic <b>WILLIAM HALLIDAY</b>
11:30 AM – 11:45 AM WED. DEC. 12	Assessing vessel slowdown for reducing auditory masking for marine mammals of the western Canadian Arctic <b>MATTHEW K. PINE</b>
11:45 AM – 12:00 PM WED. DEC. 12	Examining the potential impact of increased vessel traffic noise on marine mammals in the proposed Tallurutiup Imanga (Lancaster Sound) National Marine Conservation Area <b>ZUZANNA KOCHANOWICZ</b>

## WEDNESDAY, DECEMBER 12, 2018

1:30 PM - 3:00 PM

9 Parallel Sessions

### IHEA02. Arctic Contaminants: Emerging Concerns ROOM 201

*Chairs: Emma Pike, Jean Allen and Eva Kruemmel*

1:30 PM – 1:45 PM WED. DEC. 12	Use of pre-industrial baselines to assess sources and pathways of metals in surface sediment of floodplain lakes in the Peace-Athabasca Delta (Alberta, Canada) <b>TANNER OWCA</b>
1:45 PM – 2:00 PM WED. DEC. 12	Trace elements in selected permafrost-affected soils of near-natural and anthropogenically-affected sites of Yamal region <b>IVAN ALEKSEEV</b>
2:00 PM – 2:15 PM WED. DEC. 12	<b>SCOTT ZOLKOS</b>
2:15 PM – 2:30 PM WED. DEC. 12	Collapsing permafrost as a source of total mercury and methyl mercury to downstream ecosystems <b>KYRA ST. PIERRE</b>
2:30 PM – 2:45 PM WED. DEC. 12	Amino acid and sulfur stable isotopes in thick-billed murre prey: relationships to prey diet and contaminant signatures <b>KYLE ELLIOTT</b>
2:45 AM – 3:00 PM WED. DEC. 12	Predicting population-level impacts of contaminants in marine mammals <b>JEAN-PIERRE DESFORGES</b>

### IHEA09. One Health in the North ROOM 202

*Chairs: Emily Jenkins and Patrick Leighton*

1:30 PM – 1:45 PM WED. DEC. 12	Metacestode infections with echinococcus spp. and versteria sp. in human: changing patterns of disease over a 15-year period <b>SAPHA BARKATI</b>
1:45 PM – 2:00 PM WED. DEC. 12	Development of a molecular method to detect and identify taeniid eggs in fresh produce <b>CAROLINE FREY</b>

2:00 PM – 2:15 PM WED. DEC. 12	Prevalence, distribution, diversity, and improved diagnostics for zoonotic echinococcus spp. in the Canadian North <b>TEMITOPE KOLAPO</b>
2:15 PM – 2:30 PM WED. DEC. 12	Patterns of mental health-related visits at community nursing clinics in Nunatsiavut: A population-based study <b>JACQUELINE MIDDLETON</b>
2:30 PM – 2:45 PM WED. DEC. 12	Factors influencing the mental wellness of community health workers in Nain, Nunatsiavut <b>CHRISTINA HACKETT</b>
2:45 AM – 3:00 PM WED. DEC. 12	Sled dogs as sentinels for people living in rural alaskan communities <b>ARLEIGH REYNOLDS</b>

## **KM05. Community-Based Monitoring and Surveillance in the Circumpolar North** **ROOM 203**

*Chairs: Ashlee Cunsolo, Sherilee Harper, Cedric Yansouni, David Goldfarb and Tom Wong*

1:30 PM – 1:45 PM WED. DEC. 12	Clyde River Knowledge Atlas: Linking Inuit knowledge and technology to mobilize knowledge at the community level <b>MIKE JAYPOODY</b>
1:45 PM – 2:00 PM WED. DEC. 12	Advances made, and lessons learned in developing a collaborative open-data platform for community-based water monitoring <b>LINDSAY DAY</b>
2:00 PM – 2:15 PM WED. DEC. 12	Lessons learned from mapping permafrost vulnerability in Northern communities <b>LOUIS-PHILIPPE ROY</b>
2:15 PM – 2:30 PM WED. DEC. 12	Researching migratory fish in a changing watershed: a community-based model <b>RACHEL HOVEL</b>
2:30 PM – 2:45 PM WED. DEC. 12	Migratory patterns of Whitefish in the Mackenzie Delta Region <b>EMMA HODGSON</b>
2:45 AM – 3:00 PM WED. DEC. 12	Community health monitoring of Narwhal ( <i>Monodon monoceros</i> ): Necropsy findings 2013-2017 <b>SANDRA BLACK</b>

## **TER06. Functions of the Arctic Tundra Ecosystem Under Rapid Environmental Change** **ROOM 204**

*Chairs: Vincent Maire, Masaki Uchida and Esther Lévesque*

1:30 PM – 1:45 PM WED. DEC. 12	Climate change impacts on tundra ecosystems: Perspectives from the past <b>KONRAD GAJEWSKI</b>
1:45 PM – 2:00 PM WED. DEC. 12	Snowmelt monitoring in small Arctic catchments with TerraSAR-X - A case study from Qikiqtaruk (Herschel Island) <b>SAMUEL STETTNER</b>
2:00 PM – 2:15 PM WED. DEC. 12	Using visible and near-infrared spectral reflectance to estimate tundra vegetation biodiversity, Qikiqtaruk – Herschel Island, Canada <b>ALISON BEAMISH</b>

- 2:15 PM – 2:30 PM  
WED. DEC. 12 | Erect shrubs modulate carbon distribution in soils of the Qarlikturvik Valley prostrate tundra, Bylot Island, Nunavut  
**VINCENT MAIRE**
- 2:30 PM – 2:45 PM  
WED. DEC. 12 | Effect of plant community structure on soil respiration of tundra ecosystem through multiple ecosystem functions in Canadian Arctic  
**SHOTA MASUMOTO**
- 2:45 AM – 3:00 PM  
WED. DEC. 12 | Simulation of ecosystem carbon cycle in Ny-Ålesund, Norwegian High Arctic under environmental change  
**MASAKI UCHIDA**

**POL07. Knowledge to Decision and Policy-Making: Approaches of Arctic Nations ROOM 209**

*Chairs: Brendan Kelly, Leah Braithwaite and Amy Lauren Lovecraft*

- 1:30 PM – 1:45 PM  
WED. DEC. 12 | Auditing the Federal Government's Responsibilities in the Arctic  
**GEORGE STUETZ**
- 1:45 PM – 2:00 PM  
WED. DEC. 12 | Is bigger always better? Why Arctic policy-making needs big and thick data  
**DIANE YODER**
- 2:00 PM – 2:15 PM  
WED. DEC. 12 | Defining common interests, enhancing capacity, working together: An overview of the creation of a research/government collaboration in Nunatsiavut  
**MELANIE FLYNN**
- 2:15 PM – 2:30 PM  
WED. DEC. 12 | Imappivut (Our Oceans) marine plan: Recognizing people and place in decision-making  
**MARY DENNISTON**
- 2:30 PM – 2:45 PM  
WED. DEC. 12 | Restoring public trust: Evolution in the North American model of wildlife management  
**STEPHEN DECKER**
- 2:45 PM – 3:00 PM  
WED. DEC. 12 | ENGO Partnership Potential in the North: The Case of Greenpeace and Clyde River  
**DANITA CATHERINE BURKE**

**TER02. Arctic Freshwater Systems ROOM 210**

*Chairs: Yohanna Klanten, João Canário, Warwick F. Vincent and Diogo Folhas*

- 1:30 PM – 1:45 PM  
WED. DEC. 12 | The effect of scale on the relative importance of climatic and biotic variables influencing methane fluxes from an Arctic wet sedge meadow  
**EMMA RILEY**
- 1:45 PM – 2:00 PM  
WED. DEC. 12 | Carbon cycling and Methane Dynamics in the Mackenzie River Floodplain Delta  
**MITCHELL BERGSTRESSER**
- 2:00 PM – 2:15 PM  
WED. DEC. 12 | Importance of rock flour to carbon cycling in glacial river systems of the Lake Hazen watershed  
**PAUL DAINARD**
- 2:15 PM – 2:30 PM  
WED. DEC. 12 | Impacts of climate change and intensive lesser snow goose (*Chen caerulescens caerulescens*) activity on surface water in high Arctic pond complexes  
**KIYO CAMPBELL**

2:30 PM – 2:45 PM  
WED. DEC. 12 | Assessing the Hydrological Variability of Lakes between Inuvik and Tuktoyaktuk  
EVAN WILCOX

**TER01. Arctic Ecosystems and Wildlife**

**ROOM 211**

*Chairs: Jesper Bruun Mosbacher and Jean-Pierre Desforges*

1:30 PM – 1:45 PM  
WED. DEC. 12 | Hyperabundant Arctic geese are affecting tundra habitats and sympatric birds  
PAUL SMITH

1:45 PM – 2:00 PM  
WED. DEC. 12 | Can goose colonies supported by anthropogenic activities in temperate ecosystems affect the activity of tundra predators?  
A multi-site comparison conducted at a circumpolar scale  
AUDREY BÉDARD

2:00 PM – 2:15 PM  
WED. DEC. 12 | What happens when you add preys to an arctic ecosystem? Modeling the apparent competition between snow goose and semipalmated sandpiper  
SARAH JACQUES

2:15 PM – 2:30 PM  
WED. DEC. 12 | Risky business: Effects of human habitation on predation risk and nest survival of sub-arctic nesting shorebirds  
TAYLOR BROWN

2:30 PM – 2:45 PM  
WED. DEC. 12 | Potential for competition between eastern migratory caribou and muskoxen in Nunavik  
ALEXIS BRODEUR

2:45 AM – 3:00 PM  
WED. DEC. 12 | Local and regional landscapes of fear: Using citizen science and a non-invasive index of stress to assess snowshoe hare perception of risk  
SOPHIA LAVERGNE

**MAR08. The Greater Hudson Bay Marine Region**

**ROOM 212**

*Chairs: Lauren Candlish and Zou Zou Kuzyk*

1:30 PM – 1:45 PM  
WED. DEC. 12 | Glucocorticoids mediate short-, but not long-term, life history trade-offs in a seabird  
OLIVER LOVE

1:45 PM – 2:00 PM  
WED. DEC. 12 | The making of baselines of epibenthic communities in the Hudson Bay Complex  
MARIE PIERREJEAN

2:00 PM – 2:15 PM  
WED. DEC. 12 | Underwater videography as a window into the health of James Bay Eelgrass  
NICHOLAS ANDERSON

2:15 PM – 2:30 PM  
WED. DEC. 12 | Hatching time of *Boreogadus saida* in Hudson Bay; Further testing of the freshwater winter refuge hypothesis  
SARAH SCHEMBRI

2:30 PM – 2:45 PM  
WED. DEC. 12 | Wintertime diel vertical migration under sea ice in Hudson Bay  
VLDISLAV PETRUSEVICH

2:45 AM – 3:00 PM  
WED. DEC. 12 | Variability in daily pCO<sub>2</sub> cycles in the lower Churchill River  
DAVID CAPELLE

**POL08. Managing the Social and Ecological Impacts of Marine Vessel Traffic in the Arctic ROOM 102**

*Chairs: Natalie Carter and William Halliday*

- 1:30 PM – 1:45 PM  
WED. DEC. 12 | Inuit Marine Monitoring Program  
JEFFREY MAURICE
- 1:45 PM – 2:00 PM  
WED. DEC. 12 | Shipping in the Barents area: Local impacts and adaptive responses  
JULIA OLSEN
- 2:00 PM – 2:15 PM  
WED. DEC. 12 | Temporal and spatial trends of marine tourism in the Canadian Arctic: Risks and opportunities  
MELISSA WEBER
- 2:15 PM – 2:30 PM  
WED. DEC. 12 | Media representations of Arctic tourism – The case of the Crystal Serenity  
MATHIEU LANDRIAULT
- 2:30 PM – 2:45 PM  
WED. DEC. 12 | A tale of two hamlets – The role of a tourism champion in the relative success of the 2016 visit of the Crystal Serenity to Nunavut, Canada  
ANDREW ORAWIEC

**WEDNESDAY, DECEMBER 12, 2018**

**3:30 PM - 5:00 PM**

*9 Parallel Sessions*

**IHEA02. Arctic Contaminants: Emerging Concerns ROOM 201**

*Chairs: Emma Pike, Jean Allen and Eva Kruemmel*

- 3:30 PM – 3:45 PM  
WED. DEC. 12 | Microplastics in the Beluga Food Web  
RHIANNON MOORE
- 3:45 PM – 4:00 PM  
WED. DEC. 12 | Contaminants in Salmonids from the Kitikmeot Region, Nunavut: Collaborative Efforts with Between King William Island Residents and Southerners  
VIRGINIA WALKER
- 4:00 PM – 4:15 PM  
WED. DEC. 12 | Canada's engagement in the Arctic Council Arctic Contaminants Action Program (ACAP)  
NORAH FOY
- 4:15 PM – 4:30 PM  
WED. DEC. 12 | Inuit Circumpolar Council (ICC) – Global actions on contaminants  
EVA KRUEMMEL

**KM04. Communicating Science ROOM 202**

*Chairs: Dustin Whalen and Paul Sokoloff*

- 3:30 PM – 3:45 PM  
WED. DEC. 12 | Seasonal cycles in Nunavik: Communicating environmental observations from the CAIMAN Network  
YVES GAUTHIER
- 3:45 PM – 4:00 PM  
WED. DEC. 12 | Using online platforms to communicate science and stimulate international public engagement  
JEAN HOLLOWAY

- 4:00 PM – 4:15 PM  
WED. DEC. 12 | High school citizen science – contributory outreach in historical climate research  
MATTHEW AYRE
- 4:15 PM – 4:30 PM  
WED. DEC. 12 | Beyond the gallery: Full spectrum Arctic botany outreach at the Canadian Museum of Nature  
PAUL SOKOLOFF
- 4:30 PM – 4:45 PM  
WED. DEC. 12 | Using ArcGIS Story Map as tool to educate and facilitate geo-spatial knowledge transfer  
DAVONNA KASOOK
- 4:45 PM – 5:00 PM  
WED. DEC. 12 | Constraints on climate change communication in the central Arctic  
CHUI-LING TAM

**KM05. Community-Based Monitoring and Surveillance in the Circumpolar North ROOM 203**

*Chairs: Ashlee Cunsolo, Sherilee Harper, Cedric Yansouni, David Goldfarb and Tom Wong*

- 3:30 PM – 3:45 PM  
WED. DEC. 12 | "It depends...." Considering Inuit-identified metrics in context for monitoring and responding to climate change in the Circumpolar North  
ALEXANDRA SAWATZKY
- 3:45 PM – 4:00 PM  
WED. DEC. 12 | Accessing and assessing environmental information: Community-identified metrics and modifiers that matter in a changing climate  
JACQUELINE MIDDLETON
- 4:00 PM – 4:15 PM  
WED. DEC. 12 | Bridging the digital divide to support community-based monitoring in the Circumpolar North  
DANIEL GILLIS
- 4:15 PM – 4:30 PM  
WED. DEC. 12 | Impact of implementation of gastrointestinal pathogen molecular testing in the Qikiqtaaluk region, Nunavut  
DAVID GOLDFARB
- 4:30 PM – 4:45 PM  
WED. DEC. 12 | Mobile laboratories: bringing diagnostic capacity to remote northern communities to improve tuberculosis detection and control  
GUILLAUME POLIQUIN
- 4:45 PM – 5:00 PM  
WED. DEC. 12 | Potential impact of decreasing turnaround time of cerebrospinal fluid enterovirus polymerase chain reaction (PCR) testing in hospitalized children  
CHELSEA CAYA

**TER06. Functions of the Arctic Tundra Ecosystem Under Rapid Environmental Change ROOM 204**

*Chairs: Vincent Maire, Masaki Uchida and Esther Lévesque*

- 3:30 PM – 3:45 PM  
WED. DEC. 12 | Bacterial communities and diversities in tundra soils from Canadian Arctic  
RYO KANEKO
- 3:45 PM – 4:00 PM  
WED. DEC. 12 | Developing microbial community baseline data to support biodiversity monitoring in the Cambridge Bay area of the Arctic  
CHARLES GREER
- 4:00 PM – 4:15 PM  
WED. DEC. 12 | Biogeography of Arctic White Heather (*Cassiope tetragona*)  
CASSANDRA ELPHINSTONE

- 4:15 PM – 4:30 PM  
WED. DEC. 12 | Vascular synphenology of arctic plant communities in south-eastern Victoria Island, Nunavut: A comparison of 2015 and 2018 growing seasons  
JOHANN WAGNER
- 4:30 PM – 4:45 PM  
WED. DEC. 12 | Change in multi-taxa communities along an environmental gradient in the Canadian subarctic tundra  
RYO KITAGAWA
- 4:45 PM – 5:00 PM  
WED. DEC. 12 | The effects of climate change on terrestrial ecosystems in the Hudson Bay Lowlands  
HILARY WHITE

## MAR01.

### Arctic Marine Benthic Ecosystems: From Local to Pan-Arctic Scales

ROOM 209

*Chairs: Philippe Archambault, Dieter Piepenburg and Kathleen MacGregor*

- 3:30 PM – 3:45 PM  
WED. DEC. 12 | Ecological approach of the importance of sea ice algae as a carbon source to the deep sea benthic food web using sea ice proxy biomarkers and stable isotope analyses in Baffin Bay, Canadian Arctic  
GUSTAVO YUNDA-GUARIN
- 3:45 PM – 4:00 PM  
WED. DEC. 12 | Characterization of benthic community structure, biodiversity and activity from contrasting regions of ice cover in the western Barents Sea  
JASMIN A. GODBOLD
- 4:00 PM – 4:15 PM  
WED. DEC. 12 | Size structure and carbonate content in cold-water soft corals  
BÁRBARA DE MOURA NEVES
- 4:15 PM – 4:30 PM  
WED. DEC. 12 | First ROV observations of the cold-water reef-building coral *Lophelia pertusa* in Southwest Greenland  
BÁRBARA DE MOURA NEVES
- 4:30 PM – 4:45 PM  
WED. DEC. 12 | Preliminary results of WWF-Canada's Eastern Arctic marine conservation network design project  
MARTINE GIANGIOPPI
- 4:45 PM – 5:00 PM  
WED. DEC. 12 | An innovative approach to public outreach in support of the conservation and promotion of ecologically important areas in Baffin Bay and Davis Strait, Canada  
ELIZABETH HILTZ

## TER02.

### Arctic Freshwater Systems

ROOM 210

*Chairs: Yohanna Klanten, João Canário, Warwick F. Vincent and Diogo Folhas*

- 3:30 PM – 3:45 PM  
WED. DEC. 12 | Improving drinking water in Pond Inlet: Inuit researchers advancing monitoring capacity for water sources and supply system  
TIM ANAVIAPIK SOUCIE
- 3:45 PM – 4:00 PM  
WED. DEC. 12 | Understanding the effects of industry on the Peace-Athabasca Delta (Canada): developing baseline hydrological conditions and sediment metal concentrations using paleolimnology  
JELLE FABER
- 4:00 PM – 4:15 PM  
WED. DEC. 12 | Impact and recovery of sediment and particulate carbon fluxes from disturbed permafrost watersheds  
CASEY BEEL



- 4:15 PM – 4:30 PM  
WED. DEC. 12 | Stuckberry Valley Lakes: Sentinels of environmental change at Canada's Extreme Northern Limit  
YOHANNA KLANTEN
- 4:30 PM – 4:45 PM  
WED. DEC. 12 | Cold ice in a warm bath; Proglacial lake temperature observations from an actively calving Arctic glacier front and space  
ADRIAN DYE
- 4:45 PM – 5:00 PM  
WED. DEC. 12 | Aerosol viruses released from the melting cryosphere: sentinel microorganisms for a changing Arctic  
CATHERINE GIRARD

**IHEA04. Empowering Northern Communities to Respond to Climate Change Impacts ROOM 211**

*Chairs: Miki Ehrlich, Ben Linaker and Donna Sinnett*

- 3:30 PM – 3:45 PM  
WED. DEC. 12 | Empowering northern communities to respond to climate change impacts: progress, challenges and lessons learned  
BEN LINAKER
- 3:45 PM – 4:00 PM  
WED. DEC. 12 | Mobilizing Knowledge for Developing Indigenous Community Champions for Climate Change Adaptation in Yukon  
JASMINE GATENSBY
- 4:00 PM – 4:15 PM  
WED. DEC. 12 | Tł̨chq̨ Dq̨taàts'eedi (Tł̨chq̨ sharing food amongst the people)  
PAUL CRESSMAN
- 4:15 PM – 4:30 PM  
WED. DEC. 12 | Arviat Young Hunters Ujjiqsuiniq Program  
KUKIK BAKER
- 4:30 PM – 4:45 PM  
WED. DEC. 12 | Identifying and mapping Natural Hazards within Kangiqsujuaq surrounding areas  
VERONIQUE GILBERT
- 4:45 PM – 5:00 PM  
WED. DEC. 12 | Community driven solutions for increasing food security resilience in Nunatsiavut  
KRISTEEN MCTAVISH

**MAR08. The Greater Hudson Bay Marine Region ROOM 212**

*Chairs: Lauren Candlish and Zou Zou Kuzyk*

- 3:30 PM – 3:45 PM  
WED. DEC. 12 | Spatial distribution of riverine tracers in southeast Hudson Bay  
CELINE GUEGUEN
- 3:45 PM – 4:00 PM  
WED. DEC. 12 | River influence on the salinity of the eastern James Bay  
URS NEUMEIER
- 4:00 PM – 4:15 PM  
WED. DEC. 12 | NEMO modelling in and around the Hudson Bay Complex  
PAUL MYERS
- 4:15 PM – 4:30 PM  
WED. DEC. 12 | Full year waves records for two locations in Hudson Bay/Straight, Nunavik  
URS NEUMEIER

- 4:30 PM – 4:45 PM  
WED. DEC. 12 | The anomalous sea ice growth and drift in the Hudson Bay in 2017/18 caused by the enhanced cyclonic atmospheric circulation  
SERGEI KIRILLOV
- 4:45 PM – 5:00 PM  
WED. DEC. 12 | Ocean color variability in the Hudson Bay system: in situ observations and satellite validation  
LUCAS BARBEDO DE FREITAS

**IHEA06. Accessibility to Education in the North and Inuit Experiences in Post-Secondary Education ROOM 102**

*Chairs: Witold Kinsner, Alyssa Flaherty-Spence, Elise Ho-Foong and Randy Herrmann*

- 3:30 PM – 3:45 PM  
WED. DEC. 12 | Inuit Post-Secondary Education – Experiences and Recommendations through Surveys and Interviews  
ELISE HO-FOONG
- 3:45 PM – 4:00 PM  
WED. DEC. 12 | Inuit Nunangat University  
HEATHER OCHALSKI
- 4:00 PM – 4:15 PM  
WED. DEC. 12 | Determinants of Nunavimmiut postsecondary success  
MADELEINE PAWLOWSKI
- 4:15 PM – 4:30 PM  
WED. DEC. 12 | Making Room - the impact of creative traditions of making and problem solving on student motivation and persistence  
KATHY SNOW
- 4:30 PM – 4:45 PM  
WED. DEC. 12 | Supporting Inuit Qaujimajatuqangit in schools for student persistence and success in Inuit Nunangat  
MELANIE O'GORMAN
- 4:45 PM – 5:00 PM  
WED. DEC. 12 | Evaluating Contaminants Learning: the experience of the Nunavut Arctic College Environmental Technology Program's wildlife, contaminants and health workshop  
JENNIFER PROVENCHER
- 5:00 PM – 5:15 PM  
WED. DEC. 12 | An unmanned aerial system to monitor a solar-cell farm and its power grid in remote locations  
WITOLD KINSNER

**THURSDAY, DECEMBER 13, 2018**

**10:30 AM - 12:00 PM**

*10 Parallel Sessions*

**KM06. Inuit Self-Determination in Research: Implementing the National Inuit Strategy on Research ROOM 201**

*Chairs: Scot Nickels and Gregor Gilbert*

- 10:30 AM – 10:45 AM  
THU. DEC. 13 | National Perspective  
TIM ARGETSINGER
- 10:45 AM – 11:00 AM  
THU. DEC. 13 | International Perspective  
LISA KOPERQUALUK

11:00 AM – 11:15 AM THU. DEC. 13	Tri-Agency Perspective TED HEWITT
11:15 AM – 11:30 AM THU. DEC. 13	Inuit Regional Perspective SHANNON O'HARA
11:30 AM – 11:45 AM THU. DEC. 13	Focus on Priority Area #4: Ensuring Inuit Access, Ownership, and Control over Data and Information ANITA KORA

### TECH03.

## Climate Services in Canada's North: Understanding the Evolving Needs

ROOM 202

*Chairs: Kelly Montgomery and Richard Dewey*

10:30 AM – 10:45 AM THU. DEC. 13	Using unmanned aerial vehicles (UAVs) to map and monitor the effects of climate driven changes on the Western Arctic Environment: A Caribou Hills case study GARFIELD GIFF
10:45 AM – 11:00 AM THU. DEC. 13	Six years of high resolution marine data from the Cambridge Bay Observatory: How long do records need to be to detect climate change? RICHARD DEWEY
11:00 AM – 11:15 AM THU. DEC. 13	Air-sea-ice interactions during the Great Arctic Cyclone of August 2012 WILL PERRIE
11:15 AM – 11:30 AM THU. DEC. 13	A climatology of fog in the Canadian Arctic from more than half a century of surface weather observations HESTER JISKOOT
11:30 AM – 11:45 AM THU. DEC. 13	Making science outcomes accessible in Yukon: A review of climate change research trends ALISON PERRIN
11:45 AM – 12:00 PM THU. DEC. 13	Implementation of the Arctic Regional Climate Centre JOHN PARKER

### KM02.

## Co-Management, Co-Production of Knowledge and the Integration of Community-Based Monitoring to Supporting Effective Wildlife Resource Decision-Making and Inuit Self-Determination

ROOM 203

*Chairs: Jamie Snook, Kaitlin Breton-Honeyman, Tristan Pearce, Lisa Loseto, Denis Etiendem Ndeloh and Noor Johnson*

10:30 AM – 10:45 AM THU. DEC. 13	How researchers report on the role of Indigenous Knowledge in wildlife management: The "role in theory" versus the "role in practice" KATIE ROSA
10:45 AM – 11:00 AM THU. DEC. 13	Inuvialuit Settlement Region Beluga Tagging Program: A community and co-management driven success story VERNON AMOS
11:00 AM – 11:15 AM THU. DEC. 13	Coming together for caribou: Using community-led audio-visual methods to explore relationships among Inuit and caribou in Labrador DAVID BORISH

11:15 AM – 11:30 AM | Minding the gap: Using community-based monitoring data in wildlife co-management decision making  
THU. DEC. 13 | DENIS NDELOH

11:30 AM – 11:45 AM | Arctic Borderlands, community based ecological monitoring by and for Gwich'in and Inuvialuit people.  
THU. DEC. 13 | HEATHER ASHTORN

**IHEA12. Vulnerabilities, Impacts and Adaptation to Climate Change in Northern/Arctic Environments** **ROOM 204**

*Chairs: Robert Siron and Stéphanie Bleau*

10:30 AM – 10:45 AM | Human perspectives on climate variations of the coast of Labrador, 1750-1950  
THU. DEC. 13 | MARIE-MICHÈLE OUELLET-BERNIER

10:45 AM – 11:00 AM | The effect of an unusual summer storm on beluga whale habitat use and the traditional beluga harvest  
THU. DEC. 13 | KEVIN SCHARFFENBERG

11:00 AM – 11:15 AM | Climate change impact on mine industry in the Northern Canada  
THU. DEC. 13 | ÉMILIE BRESSON

11:15 AM – 11:30 AM | Exploring the effects of Arctic fox ecology on rabies epidemiology in Northern Quebec using a spatially-explicit individual-based model  
THU. DEC. 13 | AGATHE ALLIBERT

11:30 AM – 11:45 AM | Effects of climate change on the tundra biodiversity of Nunavik: Exposure, sensitivity and vulnerability  
THU. DEC. 13 | DOMINIQUE BERTEAUX

11:45 AM – 12:00 PM | Shedding a light on climate change adaptation progress and research needs in Eeyou Istchee and Nunavik (Québec, Canada)  
THU. DEC. 13 | REBECCA HENNIGS

**IHEA10. The Arctic Inspiration Prize: An Exploration of Grassroots Northern Innovation** **ROOM 209**

*Chairs: Katie Blasco and Jason Annahatak*

10:30 AM – 10:45 AM | The Arctic Inspiration Prize: Encouraging, enabling and celebrating northern innovation  
THU. DEC. 13 | MARTI FORD

10:45 AM – 11:00 AM | Measuring outcomes of technology enterprise in Inuit Nunangat: The smartICE case study  
THU. DEC. 13 | TREVOR BELL

11:00 AM – 11:15 AM | Arctic Indigenous Wellness Foundation; Urban on The Land Healing Camp  
THU. DEC. 13 | DONALD PRINCE

11:15 AM – 11:30 AM | The Unaaq Men's Association of Inukjuak: Developing hunters through intensive traditional skills development programs  
THU. DEC. 13 | TOMMY PALLISER

11:30 AM – 11:45 AM | Te(a)ch - Computer Science, Health and Wellness

THU. DEC. 13 | RYAN OLIVER

11:45 AM – 12:00 PM | Northern youth bridging research and communities: The growth and evolution of Ikaarvik  
THU. DEC. 13 | ERIC SOLOMON

### TER03. Biogeochemical Processes in Permafrost Thaw Lakes

ROOM 210

*Chairs: Yohanna Klanten, João Canário, Warwick F. Vincent and Diogo Folhas*

10:30 AM – 10:45 AM | Tracking climate-driven landscape changes and associated impacts on lakes and rivers in Old Crow Flats, Yukon, Canada  
THU. DEC. 13 | KEVIN TURNER

10:45 AM – 11:00 AM | Sulphur dynamics in permafrost Thaw Lakes  
THU. DEC. 13 | JOÃO CANÁRIO

11:00 AM – 11:15 AM | Impact of thawing permafrost in subarctic region on the Hg cycling in thermokarst pond  
THU. DEC. 13 | MARTIN PILOTE

11:15 AM – 11:30 AM | Structural characterization of natural organic matter in thermokarst lakes in the Eastern Canadian Subarctic  
THU. DEC. 13 | DIOGO FOLHAS

11:30 AM – 11:45 AM | Dissolved organic matter as a key variable in the changing arctic limnoscape  
THU. DEC. 13 | ISABELLE LAURION

### TER08. Macro and Micro Parasite-omes in the Arctic: Understanding Complex Ecological Interactions From Hosts to Ecosystems

ROOM 211

*Chairs: Susan Kutz and Oscar Aleuy Young*

10:30 AM – 10:45 AM | The effect of tar spot pathogen on host plant carbon balance and its possible consequences on a tundra ecosystem  
THU. DEC. 13 | SHOTA MASUMOTO

10:45 AM – 11:00 AM | Seasonal and regional differences influence the gut fauna of northern common eider ducks  
THU. DEC. 13 | JENNIFER PROVENCHER

11:00 AM – 11:15 AM | Thermal tolerance and local adaptation to freezing temperatures in a key nematode of Arctic ungulates: The case of *Marshallagia marshalli*  
THU. DEC. 13 | O. ALEJANDRO ALEUY

11:15 AM – 11:30 AM | Interactions between parasites and contaminants in northern eider ducks  
THU. DEC. 13 | JENNIFER PROVENCHER

11:30 AM – 11:45 AM | Protozoal population shifts across climate gradients at the Arctic/subarctic interface  
THU. DEC. 13 | MICHAEL E. GRIGG

11:45 AM – 12:00 PM | Diversity and ecology of Arctic pathogens under unprecedented disturbances; current challenges for an uncertain future  
THU. DEC. 13 | DISCUSSION

**MAR07.****Natural Laboratories as a Tool for Predicting Ecosystem Response to Future Arctic Change****ROOM 212***Chairs: Victoria Peck and Gerald Darnis*

- 10:30 AM – 10:45 AM  
THU. DEC. 13 | Marine Arctic Ecosystem Study (MARES): Mooring deployments on the Beaufort Sea shelf  
FRANCIS WIESE
- 10:45 AM – 11:00 AM  
THU. DEC. 13 | Deep-Sea loss of dissolved iron in the Arctic Ocean: Potential insight into the oceanic budget of an essential trace nutrient  
JAY CULLEN
- 11:00 AM – 11:15 AM  
THU. DEC. 13 | The ecology and evolution of methylotrophic bacteria in the Arctic Ocean  
ARTHI RAMACHANDRAN
- 11:15 AM – 11:30 AM  
THU. DEC. 13 | Contrasting bio-physical relationships between Arctic MYI and FYI  
BENJAMIN LANGE
- 11:30 AM – 11:45 AM  
THU. DEC. 13 | Upward diffusion of bottom ice dimethyl sulfide during the advanced melting stage of arctic first-year sea ice  
MARGAUX GOURDAL
- 11:45 AM – 12:00 PM  
THU. DEC. 13 | Light, mixing and the phytoplankton spring bloom at the retreating ice edge and into the pack ice  
ACHIM RANDELHOFF

**TERO1.****Arctic Ecosystems and Wildlife****OTTAWA  
SALON***Chairs: Jesper Bruun Mosbacher and Jean-Pierre Desforges*

- 10:30 AM – 10:45 AM  
THU. DEC. 13 | Arctic plant phenological responses to climate change: Evolutionary and life history trait patterns  
ZOE PANCHEN
- 10:45 AM – 11:00 AM  
THU. DEC. 13 | Responses of arctic tundra shrub species to climate change: differences between biotic and abiotic factors, and between short- and long-term effects  
QIAN GU
- 11:00 AM – 11:15 AM  
THU. DEC. 13 | Recent changes in vegetation productivity across the Bathurst caribou range  
KATHERINE DEARBORN
- 11:15 AM – 11:30 AM  
THU. DEC. 13 | Effects of spatial and temporal variation in resource availability and microclimate on the growth rates and survival of Arctic breeding shorebird chicks  
BRANDAN NORMAN
- 11:30 AM – 11:45 AM  
THU. DEC. 13 | Characterizing factors influencing stand age after fire in the Northwest Territories  
ANASTASIA SNIDERHAN

**KM10****Nunavik and Nunatsiavut Integrated Regional Impact Study, Second Iteration (IRIS 4.2)****ROOM 102***Chairs: Michel Allard and Mickaël Lemay*

- 10:30 AM – 10:45 AM  
THU. DEC. 13 | Nunavik and Nunatsiavut regional climate information update  
CARL BARRETTE

10:45 AM – 11:00 AM THU. DEC. 13	Inuit Health and Wellbeing in Nunavik and Nunatsiavut ASHLEE CUNSOLO and SHERILEE L. HARPER
11:00 AM – 11:15 AM THU. DEC. 13	Housing and community planning in Nunavik: social, environment, and design perspectives. MYLENE RIVA
11:15 AM – 11:30 AM THU. DEC. 13	One Health in the Eastern SubArctic – diseases at the interface of human, animal, and environmental health PATRICK A. LEIGHTON and EMILY J. JENKINS
11:30 AM – 11:45 AM THU. DEC. 13	Biodiversity and ecosystem dynamic PASCALE ROPARS
11:45 AM – 12:00 PM THU. DEC. 13	Extractive Industries and Economic Development in the Eastern Subarctic STEPHAN SCHOTT
12:00 PM – 12:15 PM THU. DEC. 13	Nunavik's coastal systems in a changing climate ANTOINE BOISSON

## THURSDAY, DECEMBER 13, 2018

1:30 PM - 3:00 PM

9 Parallel Sessions

### IHEA05. From Environmental Monitoring and Stewardship to a Dialogue About Training, Education and Knowledge Mobilization in Nunangat

ROOM 201

*Chairs: Jackie Kidd, Vincent L'Hérault, Shirley Tagalik and Jrene Rahm*

1:30 PM – 1:45 PM THU. DEC. 13	Youth becoming keen observers of the land and message carriers for their communities – How, when, and where? SHIRLEY TAGALIK, MEGAN MUCKPAH-GAVIN and JRENE RAHM
1:45 PM – 2:00 PM THU. DEC. 13	Introducing the Inuit field training program in the Canadian Arctic PAUL SMITH
2:00 PM – 2:15 PM THU. DEC. 13	Working towards realizing the full potential of engaging Inuit youth in professional and research activities: examples from the Nunavik Marine Region Wildlife Board FRANKIE JEAN-GAGNON
2:15 PM – 2:30 PM THU. DEC. 13	Using educational workshops on ringed seal ecology to engage Inuit youth in contaminants research DOMINIQUE HENRI
2:30 PM – 2:45 PM THU. DEC. 13	Meeting them where they are at – Evaluating innovative, culturally-contextualized training models for sustainable inuit youth employment TREVOR BELL
2:45 AM – 3:00 PM THU. DEC. 13	Mobilizing Inuit Qaujimagatuqangit for Sea-Ice Safety: A Sikumiut case study to support Inuit Self-Determination in Research KATHERINE WILSON

**KM01.****Building Comprehensive Understanding of the Kitikmeot Region and CHARS ERA: Marine, Terrestrial, and Community Perspectives****ROOM 202***Chairs: Donald McLennan, Kristina Brown, Milla Rautio and Adrian Schimnowski*1:30 PM – 1:45 PM  
THU. DEC. 13Ice ecology in Arctic lakes  
ELISE IMBEAU1:45 PM – 2:00 PM  
THU. DEC. 13How productive are lakes and ponds in the Kitikmeot Region? A first estimation of primary, bacterial and zooplankton production of Greiner Lake watershed  
GUILLAUME GROSBOIS2:00 PM – 2:15 PM  
THU. DEC. 13Characterization of Arctic fish skin and intestinal microbiomes with potential for monitoring fish health  
ERIN F. HAMILTON2:15 PM – 2:30 PM  
THU. DEC. 13Migration and overwintering habitat of anadromous Arctic char (*Salvelinus alpinus*) near Kugluktuk, Nunavut  
ROSIE SMITH2:30 PM – 2:45 PM  
THU. DEC. 13Mobilizing local knowledge from the Kitikmeot region to inform understanding of, and resulting co-management strategies for, the dolphin and union caribou herd  
ANDRE HANKE**KM02.****Co-Management, Co-Production of Knowledge and the Integration of Community-Based Monitoring to Supporting Effective Wildlife Resource Decision-Making and Inuit Self-Determination****ROOM 203***Chairs: Jamie Snook, Kaitlin Breton-Honeyman, Tristan Pearce, Lisa Loseto, Denis Etiendem Ndeloh and Noor Johnson*1:30 PM – 1:45 PM  
THU. DEC. 13Co-design, co-delivery of a new beluga tagging program in the Inuvialuit Settlement Region  
SHANNON MACPHEE1:45 PM – 2:00 PM  
THU. DEC. 13Documenting Inuit Knowledge of light goose population dynamics in the Kivalliq region, Nunavut: Implications for wildlife co-management and knowledge co-production in Inuit Nunangat  
DOMINIQUE HENRI2:00 PM – 2:15 PM  
THU. DEC. 13Improving resource management using TK and community-based monitoring  
PETER EVANS2:15 PM – 2:30 PM  
THU. DEC. 13Honouring the integrity of indigenous knowledge systems through a knowledge coevolution framework  
JACQUELINE CHAPMAN2:30 PM – 2:45 PM  
THU. DEC. 13Listing the polar bear as a threatened species has resulted in the death of more bears  
TRISTAN PEARCE**TECH02.****IEEE Arctic and Northern Ocean Forum – Remote Sensing and Modeling for the North****ROOM 204***Chairs: Dustin Isleifson, Wooil Moon and Ian Jeffrey*



1:30 PM – 1:45 PM THU. DEC. 13	Spaceborne SAR data assimilation in numerical sea ice prediction system ALEXANDER KOMAROV
1:45 PM – 2:00 PM THU. DEC. 13	TerraSAR-X and time-lapse photography for snow on sea-ice monitoring in Deception Bay, Nunavik SOPHIE DUFOUR-BEAUSÉJOUR
2:00 PM – 2:15 PM THU. DEC. 13	Remote sensing of freshwater ice phenology in Canada's North in the era of abundant open-access satellite imagery XAVIER GIROUX-BOUGARD
2:15 PM – 2:30 PM THU. DEC. 13	Sea ice surface feature characterization and surface roughness quantification from UAV imagery MADISON HARASYN
2:30 PM – 2:45 PM THU. DEC. 13	Sea ice concentration estimation using deep learning: Recent work and future prospects ANDREA SCOTT
2:45 AM – 3:00 PM THU. DEC. 13	A new full-wave electromagnetics solver for fast analysis of microwave scattering from sea ice DUSTIN ISLEIFSON

## **POL04. Extractive Industries and Sustainable Livelihoods in the Arctic**

**ROOM 209**

*Chairs: Thierry Rodon and Stephan Schott*

1:30 PM – 1:45 PM THU. DEC. 13	"It depends on what you refer to as 'on the land'": How assessment mechanisms may further dispossess Indigenous peoples of land, culture, identity and health and well-being JEN JONES
1:45 PM – 2:00 PM THU. DEC. 13	Consultation, discussion, and partnership: An analysis of of the Baffinland consultation meeting transcripts WILLOW SCOBIE
2:00 PM – 2:15 PM THU. DEC. 13	Mining-induced flooding and use of deterrents for mitigating impacts on Arctic nesting birds GILLIAN HOLMES
2:15 PM – 2:30 PM THU. DEC. 13	The politics of consent : IA and IBA in the context of Canada Northern Land Claims Settlement THIERRY RODON

## **MAR02. Arctic Marine Mammals**

**ROOM 210**

*Chairs: Lisa Loseto and Steve Ferguson*

1:30 PM – 1:45 PM THU. DEC. 13	Pathogens and Heavy Metal content in Ringed Seals in Iqaluit, NU ENOOYAQ SUDLOVENICK
1:45 PM – 2:00 PM THU. DEC. 13	Spatial ecology of ringed seals across a latitudinal gradient in the eastern Canadian Arctic CODY CARLYLE
2:00 PM – 2:15 PM THU. DEC. 13	Dive behaviour of Beaufort Sea beluga whales ( <i>Delphinapterus leucas</i> ) in relation to seafloor depth, ice cover, and prey distribution LUKE STORRIE

- 2:15 PM – 2:30 PM  
THU. DEC. 13 | Ecological regime change in the Arctic may be preventing complete post-whaling recovery of bowhead whales  
**STEVE FERGUSON**
- 2:30 PM – 2:45 PM  
THU. DEC. 13 | A decrease in the sea ice carbon pathway of benthic fauna in a warming Arctic: Atlantic walrus (*Odobenus rosmarus*) as a bioindicator of sea ice ecosystem variability  
**DAVID YURKOWSKI**

**TER05. From Causes to Consequences: Understanding Permafrost Dynamics and Their Influence on Ecosystems and Communities – Canadian Permafrost Association** **ROOM 211**

*Chairs: Ashley Rudy, Antoni Lewkowicz, Carolyn Gibson and Anne-Marie LeBlanc*

- 1:30 PM – 1:45 PM  
THU. DEC. 13 | Assessing permafrost-shrub interactions in the Torngat Mountains National Park, northern Labrador  
**ROBERT WAY**
- 1:45 PM – 2:00 PM  
THU. DEC. 13 | Thermal state of permafrost at sites in northern British Columbia and southern Yukon, Canada  
**ANTONI LEWKOWICZ**
- 2:00 PM – 2:15 PM  
THU. DEC. 13 | Spatial and interannual variation in surface offset near Lac de Gras, Northwest Territories, for 2015–16 and 2016–17  
**EMILIE STEWART-JONES**
- 2:15 PM – 2:30 PM  
THU. DEC. 13 | Investigation of seasonal interactions between microtopography, snow cover and ground surface temperature in a High-Arctic area  
**HADI MOHAMMADZADEH KHANI**
- 2:30 PM – 2:45 PM  
THU. DEC. 13 | Climate sensitivity of high Arctic permafrost terrain demonstrated by widespread ice-wedge thermokarst across the Canadian Arctic Archipelago  
**ROBERT FRASER**
- 2:45 AM – 3:00 PM  
THU. DEC. 13 | The spatial distribution of ice-wedge polygons in Nunavik  
**ALEXANDRE CHIASSON**

**MAR07. Natural Laboratories as a Tool for Predicting Ecosystem Response to Future Arctic Change** **ROOM 212**

*Chairs: Victoria Peck and Gérald Darnis*

- 1:30 PM – 1:45 PM  
THU. DEC. 13 | Spring Phytoplankton Phenology in Baffin Bay  
**JOANNIE FERLAND**
- 1:45 PM – 2:00 PM  
THU. DEC. 13 | Photosynthetic capacity during the GreenEdge project: seasonal light acclimation capacity and other photosynthetic parameters of the phytoplankton community in the marginal ice zone  
**FLAVIENNE BRUYANT**
- 2:00 PM – 2:15 PM  
THU. DEC. 13 | Challenging *Phaeocystis pouchetii* against diatoms during the summer bloom of phytoplankton in Labrador fjords (Eastern Canada)  
**ARMELLE GALINE and SIMO MATCHIM**

- 2:15 PM – 2:30 PM  
THU. DEC. 13 | Bloom timing explains succession of protistan functional community structure  
ROXANE MARANGER
- 2:30 PM – 2:45 PM  
THU. DEC. 13 | The influence of sea ice on the protist sinking export in high Arctic systems  
GÉRALD DARNIS
- 2:45 AM – 3:00 PM  
THU. DEC. 13 | Interannual dynamics of the Queen Maud Gulf pelagic ecosystem  
THIBAUD DEZUTTER

**MAR04.**

**Fisheries, Fishes, and Their Ecosystems in a Changing Arctic**

**ROOM 102**

*Chairs: Maxime Geoffroy, Dominique Robert and Andrew Majewski*

- 1:30 PM – 1:45 PM  
THU. DEC. 13 | Tracing foraging niche overlap and breadth between northward-redistributing temperate and Arctic marine fish along a latitudinal gradient  
SARA PEDRO
- 1:45 PM – 2:00 PM  
THU. DEC. 13 | Ontogenetic shifts in capelin diet and isotopic niche in the Eastern Canadian Arctic  
WESLEY OGLOFF
- 2:00 PM – 2:15 PM  
THU. DEC. 13 | Fishes in the polar night  
MAXIME GEOFFROY
- 2:15 PM – 2:30 PM  
THU. DEC. 13 | Northward shifts in opportunity: Salmon in the Canadian Arctic  
KAREN DUNMALL
- 2:30 PM – 2:45 PM  
THU. DEC. 13 | Tracking the movement of coastal fishes along the Diamond-Jenness Peninsula, Victoria Island  
HARRI PETTITT-WADE
- 2:45 AM – 3:00 PM  
THU. DEC. 13 | Impact of climate changes on aquatic resources in coastal areas of the Ivvavik National Park, Yukon: The case of Dolly Varden (*Salvelinus malma*)  
JADE FALARDEAU

**THURSDAY, DECEMBER 13, 2018**

**3:30 PM - 5:00 PM**

*10 Parallel Sessions*

**IHEA05.**

**From Environmental Monitoring and Stewardship to a Dialogue About Training, Education and Knowledge Mobilization in Nunangat**

**ROOM 201**

*Chairs: Jackie Kidd, Vincent L'Hérault and Shirley Tagalik*

- 3:30 PM – 3:45 PM  
THU. DEC. 13 | Supporting Northern-led environmental monitoring initiatives through training in the use of instrument technology for ocean data collection  
MAIA HOEBERCHTS
- 3:45 PM – 4:00 PM  
THU. DEC. 13 | Contaminants and health monitoring in ringed seal near Pond Inlet, Nunavut  
JAMES SIMONEE

4:00 PM – 4:15 PM  
THU. DEC. 13 | Sharing language and learning: The Yup'ik environmental knowledge project as a teaching resource in Alaska  
PETER PULSIFER

4:15 PM – 4:30 PM  
THU. DEC. 13 | Integrated monitoring programs for northern coastal communities  
RYAN FLAGG

**KM01. Building Comprehensive Understanding of the Kitikmeot Region and CHARS ERA: Marine, Terrestrial, and Community Perspectives ROOM 202**

*Chairs: Donald McLennan, Kristina Brown, Milla Rautio and Adrian Schimnowski*

3:30 PM – 3:45 PM  
THU. DEC. 13 | Sea ice roughness from airborne laser scanner observations in the Canadian Arctic Archipelago and relationships to C- and L-band radar backscatter  
SILVIE CAFARELLA

3:45 PM – 4:00 PM  
THU. DEC. 13 | Synthetic aperture radar remote sensing based sea ice roughness mapping to inform safe travel in the Kitikmeot region of Nunavut  
REBECCA SEGAL

4:00 PM – 4:15 PM  
THU. DEC. 13 | The Canadian High Arctic Research Station (CHARS): Designing a meeting place as a meeting ground  
CAROLYNE FONTAINE

4:15 PM – 4:30 PM  
THU. DEC. 13 | The CHARS IMA – Designing and Implementing Long Term Terrestrial Ecosystem Monitoring Experiments  
DONALD MCLENNAN

4:30 PM – 4:45 PM  
THU. DEC. 13 | Integrating Research and Monitoring Across Ecosystem Realms  
Discussion led by session chairs

**KM02. Co-Management, Co-Production of Knowledge and the Integration of Community-Based Monitoring to Supporting Effective Wildlife Resource Decision-Making and Inuit Self-Determination ROOM 203**

*Chairs: Jamie Snook, Kaitlin Breton-Honeyman, Tristan Pearce, Lisa Loseto, Denis Etiendem Ndeloh and Noor Johnson*

3:30 PM – 3:45 PM  
THU. DEC. 13 | Monitoring the Inuvik Tuktoyaktuk Highway - an example of community based management and monitoring  
GERALD INGLANGASUK, SAMMY LENNIE and LENNIE EMAGHOK

3:45 PM – 4:00 PM  
THU. DEC. 13 | Beyond translating and data collecting: Furthering local research and community-based monitoring in the Kivalliq  
EZRA GREENE

4:00 PM – 4:15 PM  
THU. DEC. 13 | A literature review on refining ethics guidelines for conducting meaningful community-based, northern-led, youth-driven research in Cambridge Bay, NU  
MARGARET AMOS

4:15 PM – 4:30 PM  
THU. DEC. 13 | Community-based monitoring and data sovereignty: Learning through the ELOKA and INTAROS networks  
NOOR JOHNSON

4:30 PM – 4:45 PM  
THU. DEC. 13 | Stacks, racks, and superhacks: Community-based monitoring in the digital Age  
PETER EVANS

**TECH02.** **IEEE Arctic and Northern Ocean Forum – Remote Sensing and Modeling for the North** **ROOM 204**

*Chairs: Dustin Isleifson, Wool Moon and Ian Jeffrey*

- 3:30 PM – 3:45 PM  
THU. DEC. 13 | Remote sensing of oil spills in a sea ice environment: Investigations on oil composition and mitigation potential  
DURELL DESMOND
- 3:45 PM – 4:00 PM  
THU. DEC. 13 | Enhanced Capacity for Oil Spill Situational Awareness and Response in Nunavut (ECOSAR)  
IGOR ZAKHAROV
- 4:00 PM – 4:15 PM  
THU. DEC. 13 | Measurements of the Polarized BRDF of Arctic Macroalgae with Applications to Modelling Underwater LiDAR  
ERIC REHM
- 4:15 PM – 4:30 PM  
THU. DEC. 13 | Coordinated ground and airborne measurements of snow structure and microwave brightness temperatures over tundra  
RICHARD ESSERY
- 4:30 PM – 4:45 PM  
THU. DEC. 13 | High resolution NEMO modelling for the North with the ANHA configuration  
PAUL MYERS

**POL04.** **Extractive Industries and Sustainable Livelihoods in the Arctic** **ROOM 209**

*Chairs: Thierry Rodon and Stephan Schott*

- 3:30 PM – 3:45 PM  
THU. DEC. 13 | Corporate social responsibility and consent. Comparative perspectives on moral issues of the mining industry in New Caledonia and Canada.  
CLAIRE LEVACHER
- 3:45 PM – 4:00 PM  
THU. DEC. 13 | Mining revenues and Inuit business development in the Eastern Canadian Sub-Arctic  
ANTENEH BELAYNEH
- 4:00 PM – 4:15 PM  
THU. DEC. 13 | The impact of major mining projects on Inuit employment and residency in the Eastern Canadian Sub-Arctic  
STEPHAN SCHOTT

**MAR02.** **Arctic Marine Mammals** **ROOM 210**

*Chairs: Lisa Loseto and Steve Ferguson*

- 3:30 PM – 3:45 PM  
THU. DEC. 13 | Determining the energetic consequences of terrestrial foraging on seaduck eggs in an apex marine predator, the polar bear  
PATRICK JAGIELSKI
- 3:45 PM – 4:00 PM  
THU. DEC. 13 | Variation in diet and weaning age among narwhals (*Monodon monoceros*) using stable isotope analysis of dentine from embedded tusks  
SHU-TING ZHAO
- 4:00 PM – 4:15 PM  
THU. DEC. 13 | Diet composition of ringed seals (*Pusa hispida*) in Hudson Bay revealed using stable isotopes  
CASSANDRA DEBETS

4:15 PM – 4:30 PM  
THU. DEC. 13 | Co-design of a less invasive method for tagging Eastern Beaufort Sea beluga whales (*Delphinapterus leucas*)  
LISA LOSETO

4:30 PM – 4:45 PM  
THU. DEC. 13 | SARAH FORTUNE

**TER05. From Causes to Consequences: Understanding Permafrost Dynamics and Their Influence on Ecosystems and Communities – Canadian Permafrost Association** **ROOM 211**

*Chairs: Ashley Rudy, Antoni Lewkowicz, Carolyn Gibson and Anne-Marie LeBlanc*

3:30 PM – 3:45 PM  
THU. DEC. 13 | Phase change and water movement in shallow permafrost inferred from borehole observations of liquid water content and temperature near Yellowknife, Canada  
STEPHAN GRUBER

3:45 PM – 4:00 PM  
THU. DEC. 13 | Calibrating permafrost models using temperature time series obtained from laboratory soil column experiments  
NICHOLAS BROWN

4:00 PM – 4:15 PM  
THU. DEC. 13 | Lake shoreline evolution and permafrost-related drivers, rankin inlet, Nunavut  
ANNE-MARIE LEBLANC

4:15 PM – 4:30 PM  
THU. DEC. 13 | Identifying, monitoring and implementing adaptation measures for permafrost degradation in a community outreach perspective in Kugluk Territorial Park, Nunavut  
MARC-ANDRÉ DUCHARME

4:30 PM – 4:45 PM  
THU. DEC. 13 | Incorporating local traditional knowledge to improve permafrost studies  
FABRICE CALMELS

4:45 PM – 5:00 PM  
THU. DEC. 13 | Near real-time climate and permafrost data integration in support of the development of the community of Salluit, Nunavik  
SARAH GAUTHIER

**MAR07. Natural Laboratories as a Tool for Predicting Ecosystem Response to Future Arctic Change** **ROOM 212**

*Chairs: Victoria Peck and Gerald Darnis*

3:30 PM – 3:45 PM  
THU. DEC. 13 | Underwater noise in the Arctic: A state of knowledge review  
STEPHEN INSLEY

3:45 PM – 4:00 PM  
THU. DEC. 13 | The Canadian Arctic marine microbiome and its potential for hydrocarbon bioremediation in the Northwest passage and Hudson Bay  
MARIA A. BAUTISTA

4:00 PM – 4:15 PM  
THU. DEC. 13 | Quantifying plankton and plastic composition through the Northwest passage and Atlantic Arctic gateway  
JONATHAN FISHER

4:15 PM – 4:30 PM  
THU. DEC. 13 | Ocean acidification and biological activity in the Canadian Arctic: Insights from the carbonate system  
ALEXIS BEAUPRÉ-LAPERRIÈRE

4:30 PM – 4:45 PM  
THU. DEC. 13 | Pteropod *L. helicina* as a sentinel for ocean acidification impact on Arctic ecosystems  
VICTORIA PECK

4:45 PM – 5:00 PM  
THU. DEC. 13 | Impact of ocean acidification and microplastics of ecosystems in the Canadian Arctic Archipelago - One year on.  
VICTORIA PECK

**MAR04. Fisheries, Fishes, and Their Ecosystems in a Changing Arctic**

*Chairs: Maxime Geoffroy, Dominique Robert and Andrew Majewski*

**OTTAWA  
SALON**

3:30 PM – 3:45 PM  
THU. DEC. 13 | Microbial Ecology of traditionally Important Arctic Salmonids in Kitikmeot, Nunavut  
GERAINT ELEMENT

3:45 PM – 4:00 PM  
THU. DEC. 13 | Allocation and Sub-Allocation of Nunavut Adjacent Commercial Fisheries Resources  
CARIE HOOVER

4:00 PM – 4:15 PM  
THU. DEC. 13 | Salmon of the deep sea: First evidence for inter annual site fidelity in Greenland halibut (*Reinhardtius hippoglossoides*)  
AMANDA BARKLEY

4:15 PM – 4:30 PM  
THU. DEC. 13 | Dinoflagellate communities of the Canadian Arctic  
FATMA DHIFALLAH

4:30 PM – 4:45 PM  
THU. DEC. 13 | Mapping the Canadian Arctic marine ecosystem – A microbiological approach  
SRIJAK BHATNAGAR

4:45 PM – 5:00 PM  
THU. DEC. 13 | Hotspots of vulnerability to marine invasive species introductions: Insights from habitat suitability modelling under current and projected climate change scenarios  
KIMBERLEY L. HOWLAND

**IHEA11 Voices from the North – Candid Inuit Post-Secondary Education Student Experiences**

*Chairs: Alyssa Flaherty-Spence and Elise Ho-Foong*

**ROOM 102**

3:30 PM – 3:45 PM  
THU. DEC. 13 | IAN MCLEOD

3:45 PM – 4:00 PM  
THU. DEC. 13 | ROMANI MAKKIK

4:00 PM – 4:15 PM  
THU. DEC. 13 | LUCINA GORDON

4:15 PM – 4:30 PM  
THU. DEC. 13 | JOANNE VOISEY

**POL05. How Forms of Alternative Tourism, Such As Ecotourism, Can Provide Sustainable Development Opportunities for Arctic Communities** ROOM 201

*Chairs: Dawn R. Bazely and Lisa Rankin*

- |                                   |  |
|-----------------------------------|--|
| 8:30 AM – 8:45 AM<br>FRI. DEC. 14 | How well can sustainable tourism improve the human security of local peoples in the Arctic?<br>DAWN BAZELY   |
| 8:45 AM – 9:00 AM<br>FRI. DEC. 14 | On the similarities and differences in the Ecotourism challenges facing West Bengal, India and Nunavut, Canada<br>DAWN BAZELY  |
| 9:00 AM – 9:15 AM<br>FRI. DEC. 14 | Archaeology and alternative tourism in Nunatsiavut<br>LISA RANKIN  |
| 9:15 AM – 9:30 AM<br>FRI. DEC. 14 | The implications of climate change for polar bear tourism in Churchill Canada<br>JAMIE D'SOUZA   |
| 9:30 AM – 9:45 AM<br>FRI. DEC. 14 | Walking the talk on integrating sustainable tourism principles into an Arctic-focussed Canadian family business: The case and experiences of Adventure Canada<br>DAVID NEWLAND |

**MAR06. Mapping Twenty Thousand Years of Arctic Marine Change: Deglaciation to Present** ROOM 202

*Chairs: Mark Furze, Jean-Carlos Montero-Serrano and Anna Pieńkowski*

- |                                    |  |
|------------------------------------|--|
| 8:30 AM – 8:45 AM<br>FRI. DEC. 14  | Mapping the Canadian Arctic seafloor<br>DOMINIQUE ST-HILAIRE   |
| 8:45 AM – 9:00 AM<br>FRI. DEC. 14  | Deglacial responses in the channels of the western and central Canadian Arctic: A Younger Dryas signal?<br>MARK FURZE  |
| 9:00 AM – 9:15 AM<br>FRI. DEC. 14  | Post-glacial climatic and environmental changes in the Fury and Hecla Strait Region based on biological and geochemical proxies<br>MARC-ELIE ADAÏMÉ                                    |
| 9:15 AM – 9:30 AM<br>FRI. DEC. 14  | Thin section analysis of a marine core from M'Clintock channel, Northwest territories: micromorphological evidence for mass flows and ice shelf grounding events<br>ROBERT TROYER-RIEL |
| 9:30 AM – 9:45 AM<br>FRI. DEC. 14  | Sedimentary dynamics of the Belcher Glacier (Devon Ice Cap, Nunavut) during the last centuries<br>JADE BROSSARD  |
| 9:45 AM – 10:00 AM<br>FRI. DEC. 14 | Distribution and origin of major and trace metals and polycyclic aromatic hydrocarbons in surface sediments from the Canadian Arctic Archipelago<br>ANNE CORMINBOEUF                   |



**IHEA03.****Community Adaptation and Vulnerability in the Arctic Regions****ROOM 203***Chairs: Tristian Pearce and James Ford*

- 8:30 AM – 8:45 AM  
FRI. DEC. 14 | Local adaptive capacity for avalanche risk and infrastructure disruption in Troms, Northern Norway  
**JULIA OLSEN**
- 8:45 AM – 9:00 AM  
FRI. DEC. 14 | Can an Arctic turbot fishery adapt to climate change? An empirical study from the Pangnirtung coastal community in Baffin Island, Nunavut, Canada.  
**ERANGA GALAPPATHTHI**
- 9:00 AM – 9:15 AM  
FRI. DEC. 14 | Everything is changing so much: Aklavik's shifting beluga whale harvest  
**ELIZABETH WORDEN**
- 9:15 AM – 9:30 AM  
FRI. DEC. 14 | Nunamin Illihakvia: Learning from the land  
**TRISTAN PEARCE**
- 9:30 AM – 9:45 AM  
FRI. DEC. 14 | Ilagiilluta – "Let's Be a Family" Program, Nunavik  
**FAISCA RICHER**

**IHEA01.****Addressing Arctic Housing Challenges****ROOM 204***Chairs: Carsen Banister and William Semple*

- 8:30 AM – 8:45 AM  
FRI. DEC. 14 | Architectural adaptations: research, design, and possible futures in the North  
**PAUL MCBRIDE**
- 8:45 AM – 9:00 AM  
FRI. DEC. 14 | Housing design for the Inuit Nunangat communities, a two tier approach: Fast paced (address the housing shortage crisis) and slow paced (research and develop sustainable housing solutions)  
**SAMI TANNOURY**
- 9:00 AM – 9:15 AM  
FRI. DEC. 14 | Optimization of Indoor Air Quality (IAQ) parameters in Nunavik dwellings and its impact on the respiratory health of residents (project vent-Nunavik): microbiological part  
**JODELLE DEGOIS**
- 9:15 AM – 9:30 AM  
FRI. DEC. 14 | Feasibility of achieving near-net zero construction in Canada's North  
**CATE SOROCZAN**
- 9:30 AM – 9:45 AM  
FRI. DEC. 14 | Local perspectives on healthy aging in an Inuit community, Nunavut  
**MARIE BARON**
- 9:45 AM – 10:00 AM  
FRI. DEC. 14 | Feeling at home and being housed in Nunavut and Nunavik: Two distinct determinants of Inuit health  
**KARINE PERREAU**

**TER01.****Arctic Ecosystems and Wildlife****ROOM 209***Chairs: Jesper Bruun Mosbacher and Jean-Pierre Desforges*

- 8:30 AM – 8:45 AM  
FRI. DEC. 14 | Could climate warming in the High-Arctic lead to overheating in a cold specialist?  
**JUSTINE DROLET**

- 8:45 AM – 9:00 AM  
FRI. DEC. 14 | Observational and experimental evidence for compensatory effects of climate change on arctic-nesting shorebirds  
LAURA MCKINNON
- 9:00 AM – 9:15 AM  
FRI. DEC. 14 | Studies on the nutritional ecology and behaviour of polar bears under human care  
MALCOLM GLENNIE
- 9:15 AM – 9:30 AM  
FRI. DEC. 14 | Improving terrestrial predators' diet assessments with rodent mandibles  
DOMINIQUE FAUTEUX
- 9:30 AM – 9:45 AM  
FRI. DEC. 14 | Caribou on the menu: Diet reconstruction of wolves and black bears across the ranges of migratory caribou in northern Québec-Labrador  
MICHAËL BONIN
- 9:45 AM – 10:00 AM  
FRI. DEC. 14 | Characterization of dust emissions from an actively retreating glacier in the Canadian Yukon  
JILL BACHELDER

## TER07.

### Glacier Changes: Spatial and Temporal Variability

ROOM 210

*Chairs: Laura Thomson and Luke Copland*

- 8:30 AM – 8:45 AM  
FRI. DEC. 14 | A slippery slope: The interactions between ice and water driving the future of our ice sheets and glaciers  
CHRISTINE DOW
- 8:45 AM – 9:00 AM  
FRI. DEC. 14 | Canadian Arctic leads glacier and ice cap contributions to global sea level rise in new 2006-2016 mass balance assessment  
LAURA THOMSON
- 9:00 AM – 9:15 AM  
FRI. DEC. 14 | Atmospheric forcing of rapid marine-terminating glacier retreat in the Canadian Arctic Archipelago  
ALISON COOK
- 9:15 AM – 9:30 AM  
FRI. DEC. 14 | Jan Mayen glacier fluctuations  
JADE COOLEY
- 9:30 AM – 9:45 AM  
FRI. DEC. 14 | Scaling Arctic glacier mass balance using satellite optical albedo  
SCOTT WILLIAMSON
- 9:45 AM – 10:00 AM  
FRI. DEC. 14 | Multi-annual Analysis of the Greenland Ice Sheet between 2010 and 2017 based on TanDEM-X DEM Data  
ACHIM ROTH

## MAR03.

### Climate Change Impacts on the Arctic Ocean on Multiple Scales in Space and Time

ROOM 211

*Chairs: Will Perrie and David Atkinson*

- 8:30 AM – 8:45 AM  
FRI. DEC. 14 | Connections of Spring Atmospheric Pacific-Arctic Mode with Summer Beaufort ice  
WILL PERRIE
- 8:45 AM – 9:00 AM  
FRI. DEC. 14 | Spatial variability of winter ice velocities in response to wind and ocean current forcing in the Canadian Beaufort Sea  
DAVID FISSEL

- 9:00 AM – 9:15 AM  
FRI. DEC. 14 | Sea surface temperature variability in the North Water Polynya  
RON VINCENT
- 9:15 AM – 9:30 AM  
FRI. DEC. 14 | The distribution of bioactive trace metals through the Canadian Arctic measured during the GEOTRACES Program  
JAY CULLEN
- 9:30 AM – 9:45 AM  
FRI. DEC. 14 | Year-round atmospheric and oceanic measurements to better understand air-sea CO2 exchange in the Arctic  
BRENT ELSE

**POL09. UK-Canada Arctic Research Cooperation in Action: 2018 Bursary Programme ROOM 212**  
*Chairs: Henry Burgess and Jane Francis*

- 8:30 AM – 8:45 AM  
FRI. DEC. 14 | UK-Canada Arctic Research Cooperation - past, present and future  
HENRY BURGESS
- 8:45 AM – 9:00 AM  
FRI. DEC. 14 | Initiating a Continuous Plankton Recorder survey to monitor the gradient of change across the Western-Canadian Arctic  
CLARE OSTLE
- 9:00 AM – 9:15 AM  
FRI. DEC. 14 | Direct dating of gold-associated geological faults in the Arctic Canadian Cordillera, Yukon Territory  
CATHERINE MOTTRAM
- 9:15 AM – 9:30 AM  
FRI. DEC. 14 | Reconstructing the deglacial history of the Labrador Ice Dome on the Ungava Peninsula, Nunavik, Northern Canada  
PAUL DUNLOP
- 9:30 AM – 9:45 AM  
FRI. DEC. 14 | Quantifying the mechanisms and wider impacts of accelerated erosion in ice-rich permafrost coasts  
MICHAEL LIM
- 9:45 AM – 10:00 AM  
FRI. DEC. 14 | Capturing the landscape-context of long-term tundra vegetation change  
ISLA MYERS-SMITH

**POL01. Arctic Data Management, Access and Interoperability: Advances in National and International Programs and Initiatives ROOM 102**  
*Chairs: Maribeth Murray, Peter Pulsifer and David Arthurs*

- 8:30 AM – 8:45 AM  
FRI. DEC. 14 | A Nunaliit atlas of the Inuit language  
KUMIKO MURASUGI
- 8:45 AM – 9:00 AM  
FRI. DEC. 14 | Inuit-driven social media and research tools on the SIKU.org platform: Developing an approach to features, intellectual property and data stewardship that benefits long-term Inuit self-determination.  
JOEL HEATH
- 9:00 AM – 9:15 AM  
FRI. DEC. 14 | The Canadian Consortium for Arctic Data Interoperability: Connecting Canadian Arctic Data Infrastructures  
MARIBETH MURRAY
- 9:15 AM – 9:30 AM  
FRI. DEC. 14 | Mobilizing water data for decision-making and shared water stewardship: DataStream's collaborative open data initiative  
LINDSAY DAY

**9:30 AM – 9:45 AM** | Aboriginal Liaison Program at Statistics Canada  
FRI. DEC. 14 | **STEPHANIE KOOTOO-CHIARELLO**

**9:45 AM – 10:00 AM** | New Open High-Resolution Digital Elevation Models in Canada's North: Leveraging the ArcticDEM initiative  
FRI. DEC. 14 | **CHARLES PAPASODORO**



THE W. GARFIELD WESTON  
FOUNDATION  
NORTHERN SCIENCE & KNOWLEDGE  
ᐃᐃᐃᐃᐃᐃᐃᐃ ᐃᐃᐃᐃᐃᐃᐃᐃ ᐃᐃᐃᐃᐃᐃᐃᐃ



**Congratulations to our 2018-2019 Award Recipients!**

The W. Garfield Weston Awards for Northern Research

Postdoctoral Fellows

**Emily Choy • Sarah Fortune • Sarah Gutowsky • Zoe Panchen**

Doctoral

**Allison Patterson • Branaavan Sivarajah • Casey Remmer • Geoffrey Kershaw  
McKenzie Kuhn • Michael Price • Paul Dainard • Samuel Gagnon  
Timothy Ensom • Yasmine Majchrzak**

Masters

**Aur lie Chagnon-Lafortune • Cassandra Elphinstone • Claire Bernard-Grand'Maison  
Edith Hau Ying Li • Elise Imbeau • Enooyaq Sudlovenick • Jesse Vigliotti • Justine Drolet  
Kamil Chatila-Amos • Katie Goodwin • Kyle Lefort • Laurence Carter • Laurissa Christie  
Naima Jutha • Rhiannon Moore**

The W. Garfield Weston Awards for Northern Archaeological Research

Postdoctoral Fellows

**Michael O'Rourke**

Doctoral

**Samantha Walker • Tyler Murchie**

Masters

**Elenore Hood • Jeff Grieve**



## CALL FOR APPLICATIONS

The W. Garfield Weston Foundation and the Association of Canadian Universities for Northern Studies are pleased to announce the launch of the 2019 award cycle. The W. Garfield Weston Awards recognize individuals who demonstrate exceptional promise, academic excellence, leadership, and a strong commitment to northern natural science and archaeological research.

### **2019 Weston Family Prize for Lifetime Achievement in Northern Research**

- \$50,000 cash prize
- \$50,000 to support a research fellow, with additional funds available for travel and research expenses as well as First Nations and Inuit engagement

### **The W. Garfield Weston Award for Northern Research**

- Postdoctoral Fellowship – \$50,000 + up to \$10,000 for conference and travel expenses
- Doctoral – \$50,000
- Masters – \$15,000

### **The W. Garfield Weston Award for Northern Archaeological Research**

- Postdoctoral Fellowship – \$50,000 + up to \$10,000 for conference and travel expenses
- Doctoral – \$50,000
- Masters – \$15,000

**The deadline for applications is January 31, 2019.**

**For more details and to apply, please visit:**

**[www.acuns.ca](http://www.acuns.ca)**

**[westonawards@acuns.ca](mailto:westonawards@acuns.ca)**



# THANK YOU TO OUR PARTNERS





# EXHIBITORS



Canadian Space Agency

Agence spatiale canadienne

CHRISTINE KOCH  
 Painter and Printmaker



Eeyou Marine Region



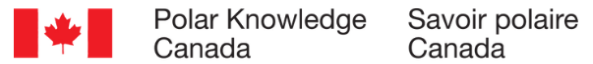

RBR

ROMOR



Sentinelle  
Nord



Sentinel  
North

Contribuez au savoir et à  
l'innovation pour le Nord

Contribute to knowledge and  
innovation for the North

BOURSES ET  
STAGES DE  
RECHERCHE

SCHOLARSHIPS  
AND TRAINING  
GRANTS



Date de tombée : 10 mars  
Deadline for applications: March 10

[sentinellenord.ulaval.ca/bourses](http://sentinellenord.ulaval.ca/bourses)

Canada



CANADA  
FIRST  
RESEARCH  
EXCELLENCE  
FUND

APOGÉE  
CANADA  
FONDS  
D'EXCELLENCE  
EN RECHERCHE



UNIVERSITÉ  
LAVAL

# Emplacement des affiches

## Poster Board allocations

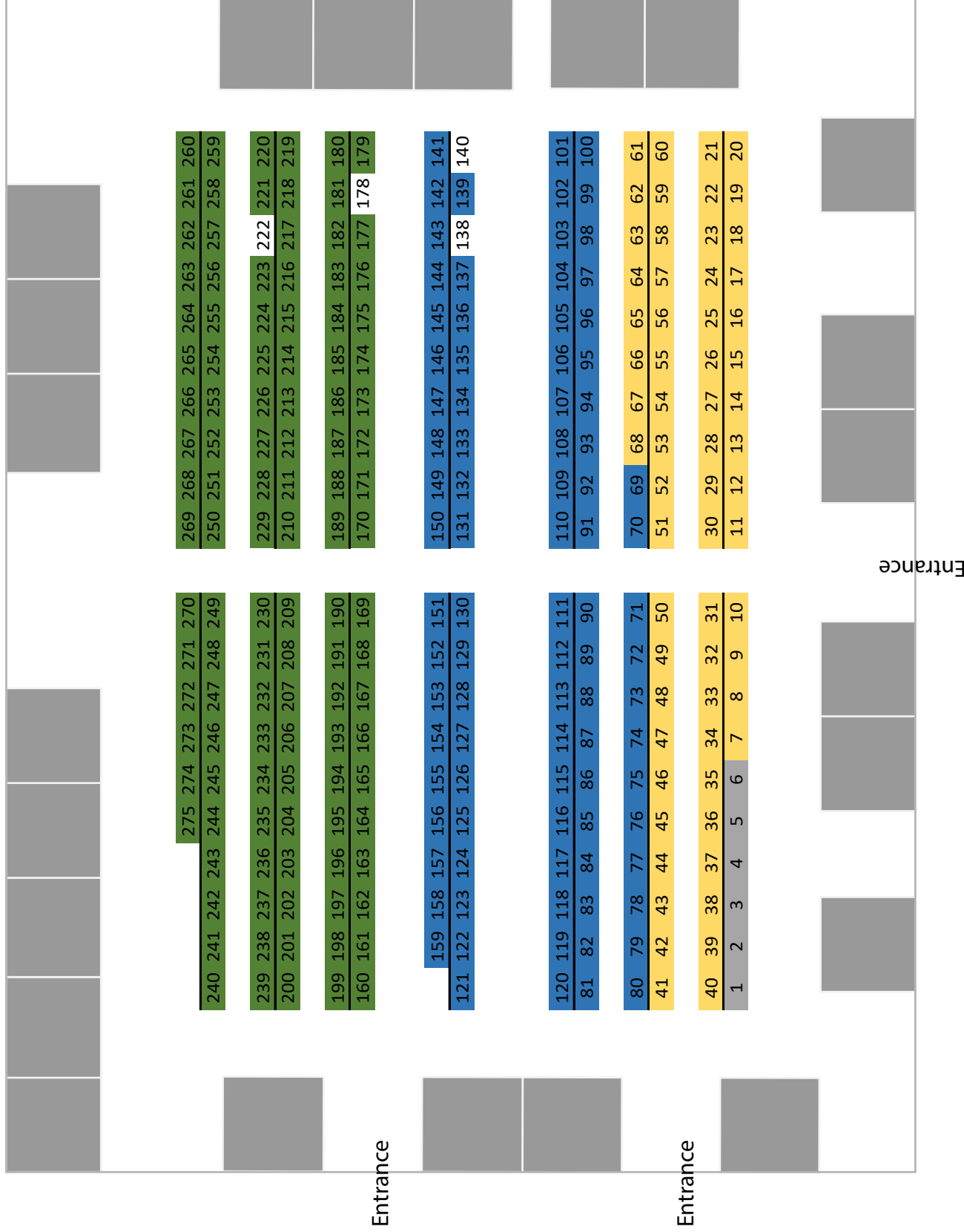
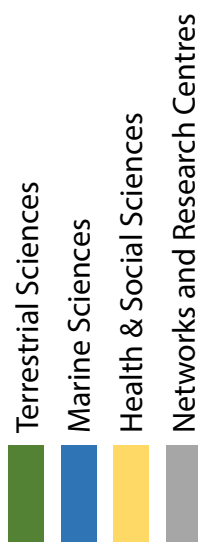

# Emplacement des affiches

-

## Poster Board allocations

### Health & Social Sciences

53 Baird, Natalie	47 Middleton, Jacqueline
7 Bhatt, Vikram	22 Moniz & Das, Kristy & Pranab
43 Bogdan, Stanciu	13 Naylor, Angus
38 Borish, David	18 Nuesslein, Shirin
34 Bresson, Émilie	58 Orawiec, Andrew
25 Casado, Mathieu	63 Parker, Colleen
35 Chaulk, Amanda	54 Passey, Kara
36 Collings, Peter	33 Pawlowski, Madeleine
20 Curry-Sharples, Brittany	11 Pearce, Tristan
19 Desautels, Jamie	62 Perrin, Alison
68 Desjardins, Emilie	24 Poliquin, Guillaume
59 Dewey, Richard	32 Prince, Donald
12 Emanuelson, Kristin	61 Ramachandran, Arthi
39 Evans, Peter	28 Reiling, Sarah
30 Frey, Caroline	27 Reynolds, Arleigh
29 Fung, Rebecca	60 Richer, Faisca
9 Galappaththi, Eranga	21 Robertson, Julie
52 Gbetholancy, Claudia	49 Sadowsky, Hilary
15 Gérin-Lajoie, José	44 Sawatzky, Alexandra
8 Gibson, Jennifer	42 Sgro, Alyssa
46 Gillis, Daniel	56 Shan, Desai
51 Girard, Catherine	10 Sohns, Antonia
50 Henri, Dominique	66 Song, Gloria
23 Khosraviyani, Parisa	65 Struchkova, Natalia
48 Kipp, Amy	67 Tam, Chui-Ling
45 Kippenhuck, Charlene	57 Totonova, Elena
55 Klatt, Calvin	16 Watts, Lauren
31 Kolapo, Temitope	17 Wilkinson, Alex
26 Kwan, Michael	14 Wilson, Katherine
41 Lapalme, Caitlin	64 Yang, Xin
37 Lyonnais, Marie-Claude	

### Marine Sciences

118 Adaimé, Marc-Elie	93 Jagielski, Patrick
152 Alikacem, Yasmine	84 Klappstein, Natasha
73 Allan, Estelle	137 Kuzyk, Zou Zou
131 Anderson, Nicholas	146 LaBrie, Richard
154 Bansept, Marc-Antoine	101 Laliberté, Julien
135 Barbedo de Freitas, Lucas	150 Lange, Benjamin
127 Beaupré-Laperrière, Alexis	141 Lazarus, Thomas
71 Binhammer, Adam	104 LeBlanc, Mathieu
88 Bissonnette, Paige	81 Lefort, Kyle
89 Boucher, Nicole	158 Li, Juan
115 Brossard, Jade	139 Loewen, Ada
74 Brown, Kristina	113 Luo, Yi
120 Cameron-Bergeron, Kasey	148 McBeth, Samantha
86 Carlyle, Cody	121 Michel, Christine
124 Charette, Joannie	125 Nadaï, Gabrielle
153 Coppolaro, Veronica	106 Neves, Barbara
116 Corminboeuf, Anne	107 Owen, Jade
75 Couture, Guillaume	102 Oziel, Laurent
122 Cramm, Margaret	147 Patterson, Allison
80 Cypihot, Valérie	149 Perron, Christophe
111 Dallaire, Xavier	92 Petersen, Stephen
112 Dalton, Abigail	132 Petrusovich, Vldislav
126 Darnis, Gérald	117 Purcell, Karl
159 Dauginis, Alicia	157 Rehm, Eric
85 Debets, Cassandra	95 Ross, Tyler
130 Deschepper, Inge	76 Rotermond, Lina
155 Desmond, Durell	99 Ryan, Kasey
105 Driver, Hannah	128 Schembri, Sarah
156 Dufour-Beauséjour, Sophie	90 Sheremata, Megan
78 Dumais, Philippe-Olivier	123 Simo Matchim, Armelle Galine
142 Eby, Alyssa	72 Simonee, James
70 Elliott, Kyle	77 Smith, Paula C.
145 Flagg, Ryan	114 Smith, Jesse
119 Fleet, Jelena	100 Storrie, Luke
98 Florko, Katie	94 Strang, Daniel
96 Fortune, Sarah	82 Sudlovenick, Enooyaq
134 Galindo, Virginie	109 Takkiruaq, Jordan
144 Gerhartz-Abraham, Adrian	133 Tefs, Andrew
143 Gremion, Gwenaelle	91 Thiemann, Gregory
97 Gryba, Rowenna	87 Togunov, Ron
129 Hayden, Anna-Mireilla	108 Tufts, Teresa
110 Hoover, Carie	79 Van Doorn, Catherine
69 Houde, Magali	103 Williams, Bill
136 Hubert, Casey	83 Zhao, Shu-Ting
151 Huot, Matthieu	

### Terrestrial Sciences

254 Alekseev, Ivan	165 Gautier, Coralie	195 Olek, Victor
206 Anderson, Christine	219 Geeves, Kimberley	194 Panchen, Zoe
262 Antropova, Yulia	199 Geldart, Erica	171 Paquette, Emmelle
166 Ayala Borda, Paola	238 Gibson, Carolyn	241 Paquette, Michel
268 Bachelder, Jill	184 Glennie, Malcolm	270 Parnikoza, Ivan
225 Baker, Rachel	200 Gousy-Leblanc, Marianne	231 Peck, Christopher
260 Bash, Eleanor	196 Grishaber, Natalie	212 Pretty, Thomas
188 Béland, Sophieane	205 Gu, Qian	224 Riley, Emma
257 Bernard-Grand'Maison, Claire	233 Guzzi, Alessia	245 Rioux, Karine
210 Blais, Marie-Amélie	173 Hann, Richard	207 Risk, Dave
267 Blankenship, Donald D.	229 Heslop, Joanne	198 Ritchie, Kyle
187 Bonin, Michaël	216 Hickman, Jennifer	192 Roy, Gabrielle
218 Bonneau, Jérémie	185 Hogan, Danica	228 Roy-Leveillee, Pascale
209 Brehaut, Lucas	164 Imbeau, Elise	247 Rudy, Ashley C.A
179 Brown, Laura	203 Jenkins, Deborah	191 Saarela, Jeffery M.
265 Brown, Rachel	217 Klanten, Yohanna	169 Sasseville, Vincent
190 Buhler, Kayla	232 Klein, Konstantin	208 Savenko, Oksana
202 Burdet, Charles	170 Kramer, Daniel	211 Schiff, Sherry
176 Campos, Jaime	183 Lang, Jessica	255 Scott, Neal
201 Chagnon-Lafortune, Auréli	272 Lantz, Trevor	264 Sharma, Rajnish
220 Chapman, Fiona	197 Léandri-Breton, Don-Jean	259 Smeda, Braden
234 Chassiot, Léo	186 Lemay, Evelyne	161 Smith, Reid
221 Chatila-Amos, Kamil	163 Lemire, Danielle	193 Sokoloff, Paul
253 Chen, Angel	167 Levasseur, Simon	204 Standen, Katherine
240 Chiasson, Alexandre	215 MacDonald, Erin	258 Stephenson, Dana
274 Cox, Erin	162 MacMillan, Gwyneth Anne	226 Thorne, Brent
227 Dainard, Paul	256 Mahanta, Kirti Kumar	213 Triglav, Katherine
271 Davesne, Gautier	261 Main, Brittany	248 Uchida, Masaki
181 Desforges, Jean-Pierre	236 Malenfant, Francois	235 Vieira, Goncalo
273 Dubnick, Ashley	249 Maslov, Mikhail	246 Voglimacci, Joëlle
266 Dwyer-Samuel, Frédéric	182 Maynard, Laurie	223 Walker, Branden
251 Elphinstone, Cassandra	175 McDonald, Renée	189 Wallace, Cory
269 Erland, Lauren	244 McFadden, Sarah I.	160 Wang, Xiaowa
242 Fraser, Robert	252 McLennan, Donald	237 Wang, Yifeng
230 Freitas, Pedro	263 Medrzycka, Dorota	275 Wehbe, Mishelle
250 Gallois, Elise	168 Meloche, Julien	172 Wood, Bryn
174 Garbo, Adam	180 Miled, Amine	177 Yahyaabadi, Amin
239 Gauthier, Sarah	243 Mohammadzadeh Khani, Hadi	214 Zolkos, Scott

### Networks & Research Centres

2 Alix, Gabrielle
5 Burgess, Henry
1 Fontaine, Carolyne
3 Kootoo-Chiarelo, Stephanie
4 Murray, Maribeth
6 Parker, John

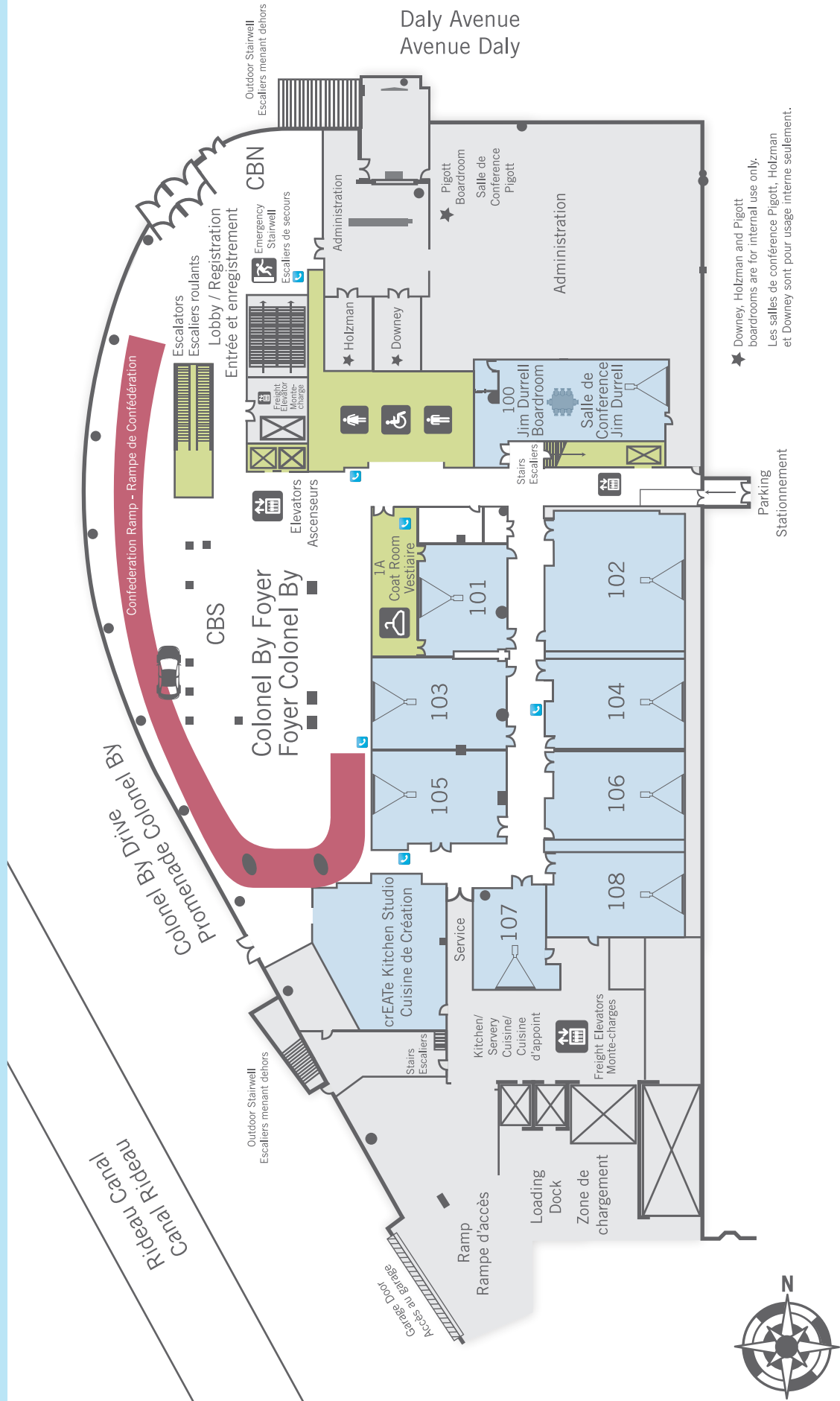

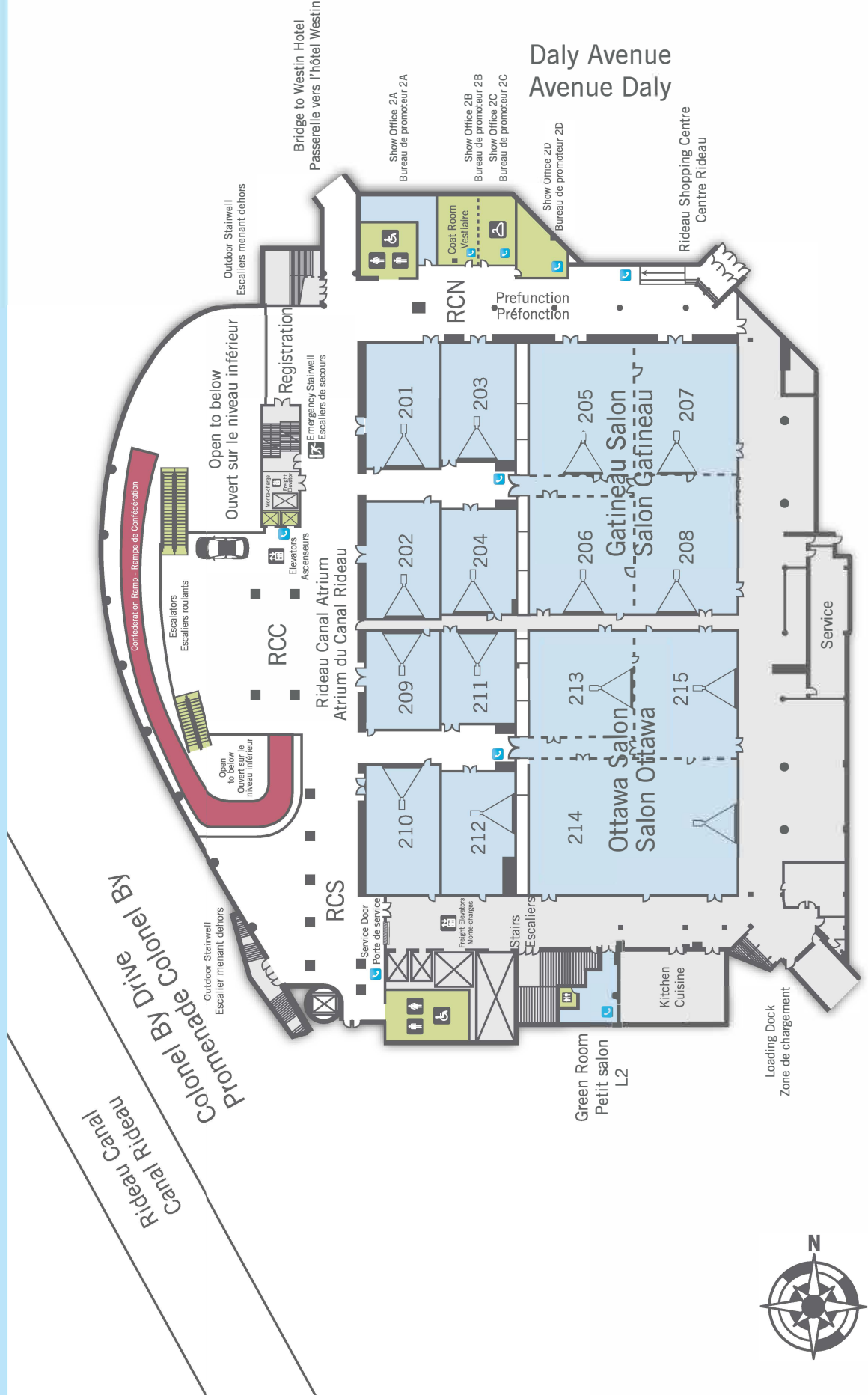



# POLAR KNOWLEDGE CANADA

## Canadian High Arctic Research Station (CHARS) campus

The mission of Polar Knowledge Canada (POLAR) is to conduct world-class cutting edge Arctic research. POLAR is responsible for advancing Canada's knowledge of the Arctic and strengthening Canadian leadership in polar science and technology, in order to improve economic opportunities, environmental stewardship, and the quality of life of Northerners and all Canadians.

The CHARS campus, operated by POLAR, will be a world-class hub for Science & Technology in Canada's North that compliments the diverse network of research facilities across the North.

The CHARS campus consists of the Main Research Building, the Field and Maintenance Building and two Triplex Accommodation Buildings for visiting researchers and scientists. It includes research labs, centres for technology development and knowledge sharing, and facilities for teaching, training, and community engagement.



# SAVOIR POLAIRE CANADA

## Le campus de la Station canadienne de recherche dans l'Extrême-Arctique (SCREA)

La mission de Savoir polaire Canada (POLAIRE) est de mener de la recherche de calibre mondial à la fine pointe des questions arctiques dans l'Extrême-Arctique canadien. POLAIRE est responsable de l'avancement des connaissances du Canada sur l'Arctique, du renforcement du leadership canadien en sciences et technologies polaires, de façon à accroître les possibilités économiques, à raffermir la gérance de l'environnement et à améliorer la qualité de vie des résidents du Nord et de tous les Canadiens.

Le campus de la SCREA, exploité par POLAIRE, constituera un centre de sciences et de technologie de calibre mondial dans le Nord du Canada qui viendra compléter et renforcer le réseau divers d'installations dans le Nord.

Le campus de la SCREA comprend l'édifice de recherche principal, le bâtiment de recherche sur le terrain et d'entretien, ainsi que deux immeubles triplex qui hébergeront les chercheurs et les scientifiques en visite. Elle comprendra des laboratoires de recherche, des centres de développement technologique et de transmission du savoir, ainsi que des installations réservées à l'enseignement, à la formation et à la participation communautaire.

## FOR MORE INFORMATION...

For more information about the research taking place at the CHARS campus, and about POLAR connect with us:

**Twitter:** @POLARCanada @POLAIRECanada  
<http://www.canada.ca/en/polar-knowledge>

## POUR EN SAVOIR PLUS...

Pour plus d'information sur la recherche qui se déroule au campus de la SCREA, et à propos de POLAIRE, communiquez avec nous :

**Facebook:** /PolarKnowledge/ /Savoirpolaire  
<http://www.canada.ca/fr/savoir-polaire>



Polar Knowledge  
Canada

Savoir polaire  
Canada

Canada

DELIVERING A HIGHER STANDARD



**FEDNAV**

# **STRENGTH IN NUMBERS**

**ibj**  
AWARDS  
2018



Winner of the  
IBJ People Development  
Award



[www.fednav.com](http://www.fednav.com)

# ArcticNet

∞ Annual Scientific Meeting  
2018 Réunion scientifique annuelle  
ᐱᓐᓂᓐᓂᓐ ᓂᓐᓂᓐ ᓂᓐᓂᓐ

December 10 -14 · Shaw Centre · Ottawa, ON

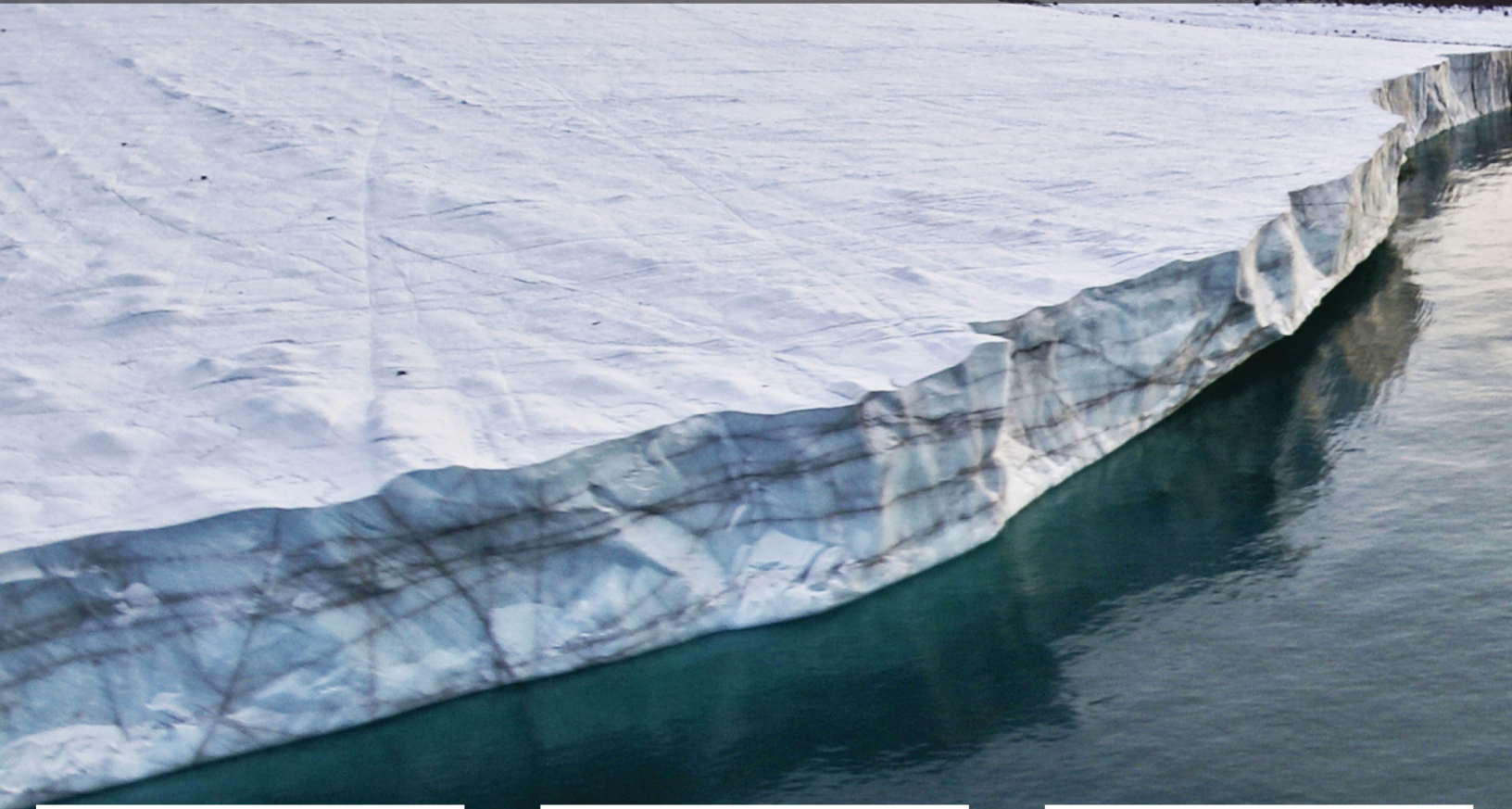

[www.arcticnetmeetings.ca/asm2018](http://www.arcticnetmeetings.ca/asm2018)